

HYUNDAI TIBURON 1997-99

SECTION INDEX

AC HEATER	889
AC REFRIGERANT CAPACITIES	889
ABS/BRAKES	891
AIR BAG SYSTEM	891
AIR CLEANER	894
CENTER CONSOLE	894
CLEAR COAT IDENTIFICATION	896
COOLING	898
COOL & DASH	895
CRUISE CONTROL SYSTEM	894
ELECTRICAL	891
EMISSION SYSTEM	894
ENGINE/TRANS	893
ENGINE/TRANS MOUNTS	893
EXHAUST	894
FRONT BUMPER	886
FRONT DOOR	897
FRONT DRIVE AXLE	892
FRONT FENDER	890
FRONT INNER STRUCTURE	888
FRONT LAMPS	890
FRONT SEAT	896
FRONT STEERING LINKAGE/GEAR	892
FRONT SUSPENSION	891
FUEL TANK	901
HOOD	888
INFORMATION LABELS	888
INSTRUMENT PANEL	895
LIFTGATE	900
PAINT CODE LOCATION	888
QUARTER GLASS	890
QUARTER PANEL	899
REAR BODY	901
REAR BUMPER	902
REAR LAMPS	901
REAR SEAT	897
REAR SUSPENSION	900
ROCKER/PILLARS/FLOOR	896
ROOF	896
SEAT BELTS	887
SPECIAL CAUTIONS	887
STEERING PUMP	892
STEERING WHEEL/COLUMN	893
SUNROOF	899
UNDERHOOD DIMENSIONS	890
WHEEL	891
WINDSHIELD	894

SPECIAL CAUTIONS

AIR BAGS

Refer to Procedure Explanation 29 for Supplemental Restraint Air Bag Special Cautions.

SUSPENSION

Manufacturer advises that some new fasteners must be used wherever old fasteners are loosened or removed.

PAINT CODE LOCATION

Paint code located on left door jamb.

CLEAR COAT IDENTIFICATION

All metallic colors are clear coat.

INFORMATION LABELS



060-00788

1 Label, Tire Pressure	05203-27001	.90
2 Label, Emission Control		
1.0, Eng	97 32450-23051	3.80
w/Coil Emission	98-99 32450-23052	3.80
w/o Coil Emission	97 32450-23041	3.80
	98-99 32450-23042	3.80
2.0, Eng		
w/Coil Emission	97 32450-23250	3.80
	98 32450-23251	3.80
	99 32450-23262	3.80
	97 32450-23240	3.80
w/o Coil Emission	98 32450-23241	3.80
	99 32450-23242	3.80
3 Label, Vacuum Hose Routing	32490-23050	4.02
4 Label, Refrigerant	87829-23000	1.67
Label, Headlamp Aiming	92111-27052	56
Label, Audio Warning	RL 19111-34002	< .26
Label, Fuel Filter	L 31033-56300	.97
Label, Air Bag-See Instrument Panel Section		

FRONT BUMPER

Use Procedure Explanations 1 and 28 with the following list.

Refresh Front Cover	1.9
R&R Cover Assy	#1.9
O/H Bumper Assy (Includes R&I)	#1.9

#Includes R&I/R&R Park/Signal Lamp Assemblies
Add to R&I or O/H Bumper Assy

NOTE: All Parts in this section are included in overhaul unless noted otherwise.

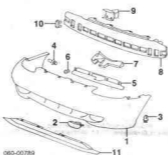

060-00789

1 Cover, Front (F)	86510-27000-PACK	#1.9	273.11
(F) Paint to Match			
#Includes R&I/R&R Park/Signal Lamp Assemblies			
2 Cover, Hole	R 96524-27000	.1	13.49
	L 96523-27000	.1	17.26
3 Retainer, Cover Side Bolt, Cover Side	RL 96939-50000		.91
4 Retainer, Cover Side	RL 11250-06181		.22
5 Guard, Cover Upper Retainer, Guard (F)	86530-27000		6.33
6 Absorber, Impact	86530-50000		1.55
	R 86522-27000		11.44
	L 86521-27000		11.44
8 Bar, Reinforcement Stay, Bumper	86531-27000	10H	240.16
	R 86543-27000	#2	56.77
	L 86541-27000	#2	56.77
#Per Cover Assy Removed. Not Included in O/H			
10 Bolt, Stay Mfg (2/Side)	RL 86548-29000		4.81
11 Spoiler, Air	29150-27000	.3	19.57

FRONT LAMPS

HEADLAMP

R&R Does Not Include Arm Lamps	RL	4
R&I Headlamp Assy	RL	#4

#Includes R&I/R&R Park/Signal Lamp Assy



060-00790

1 Headlamp Assy	R 92102-27030	#4	318.82
	L 92101-27050	#4	318.82
#Includes R&I/R&R Park/Signal Lamp Assy			
2 Holder, Bulb(s) (2/Side)	RL 92149-34050		4.19
3 Gasket, Holder(s) (2/Side)	RL 92141-34050		4.29
4 Bush, High Beam(s)	RL 19649-65009	.1	13.85
5 Bush, Low Beam(s)	RL 19649-65009	.1	13.85

9 Retainer, Upper(s)	RL 92152-28050	.37
7 Retainer, Lower(s)	RL 92150-23000	.40
8 Clip, Lamp(s) (2/Side)	RL 92151-31300	.67

#Included w/Headlamp Assy

PARK/SIGNAL LAMP

R&I Park/Signal Lamp Assy	RL	2
---------------------------	----	---

060-00791

1 Lamp Assy, Park/Signal	R 92002-27050	2	39.46
	L 92001-27050	2	39.46
2 Socket(s)	RL 92043-96050		7.55
3 Bulb(s)	RL 19644-28007	2	2.46

#Included w/Park/Signal Lamp Assy

FOG LAMP

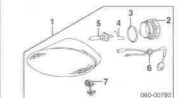

060-00792

1 Lamp Assy, Fog	R 92022-27001	#2	64.38
	L 92021-27001	#2	64.38
#Included in R&I or O/H Front Bumper			
2 Holder, Bulb(s)	RL 92042-27000		1.82
3 Gasket, Holder(s)	RL 92044-27000		.65
4 Retainer, Bulb(s)	RL 38411-53004-E		8.63
5 Bulb(s)	RL 92550-27000		9.90
6 Cable, Lamp(s)	RL 92550-27000		4.38
7 Knob, Fog Lamp Aiming(s)			

#Included w/Fog Lamp Assy

HOOD

Use Procedure Explanations 4 and 28 with the following list.

Refresh Hood Outside	2.8	
Add for Underhood	1.3	
Refresh Hinge	RL	2
R&I Hood Assy	RL	4

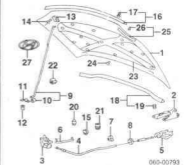

060-00793

1 Panel, Hood	68400-27011	1.0	368.72
2 Hinge	R 79120-27000	#2	20.77
	L 79110-27000	#2	20.77
#Per Hood Assy Removed			
3 Latch	81130-27010	.3	39.30
4 Cable, Latch Release	81190-27000	#1.0	23.45
5 Handle, Hood Release	81190-34000	#2	13.00
#Includes R&I Left Fender Liner			
6 Protector, Cable	81189-27000		15.83
7 Clip, Cable (2)	81190-33000		.60
8 Strap, Cable	77963-19000		.31
9 Rod Assy, Hood Stay	81170-27000	.1	18.24
10 Holder, Rod(s)	81176-34000		1.00
#Includes R&I Hood Stay Rod Assy			
11 Bracket, Stay Rod	81176-30000		1.57
12 Grommet (2)	14811-06000		.25
13 Protector, Hood Stay	81176-23100		3.01
14 Rivet, Pad	14160-04120		.26
15 Clip, Stay Rod	81174-21010		.83

16 Seal Assy, Hood Front	86435-27000	2	20.09
17 Clip, Front Seal	82132-30000		.36
Incl. w/Hood Front Seal Assy			
18 Seal Assy, Hood Rear	86430-27000	2	29.07
19 Clip, Rear Seal	82133-30000		.36
Incl. w/Hood Rear Seal Assy			
20 Bumper, Hood Stop Ad.	RL 86411-20000	1	2.30
21 Bumper, Hood Front	RL 86410-20000	1	3.94
22 Bumper, Hood Guide	RL 86145-27000	1	1.04
23 Insulator, Hood	81175-10200	3	170.89
24 Clip, Insulator (14)	81176-37010		.54
25 Strip Assy, Hood Seal	RL 86441-27000	1	16.80
	L 86437-27000	1	16.80
26 Clip, Strip(4/Side)	RL 86439-20000		.86
Incl. w/Hood Seal Strip Assy			
27 Emblem, Front	86300-20000	2	6.79

COOLING

Use Procedure Explanations 5 and 28 with the following test.

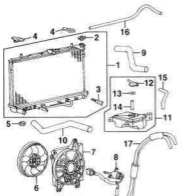

1 Radiator Assy Man Trans Auto Trans	25310-28010	2	282.44
To 10-1-96			
	25310-20700	1.0	329.34
From 10-1-96			
	25310-27000	1.0	329.34
2 Cap, Radiator Man Trans	25330-30001	6.91	
1997			
	25330-30001	6.91	
From 10-1-96 To 6-13-97			
	25330-39100	6.91	
1998-99			
	25330-39100	6.91	
3 Plug, Rad Drain Man Trans			
1997			
	25318-36560	1.42	
To 2-24-97			
	25318-37100	1.42	
From 2-24-97			
	25318-37100	1.42	
Auto Trans			
	25318-33100	1.42	
From 10-1-96			
	25318-37100	1.42	
1998-99			
	25318-37100	1.42	
Incl. w/Radiator Assy			
4 Bkt, Rad Mfg Upper	R 25333-27100	10.17	
	L 25332-27000	10.17	
5 Cushion, Rad Mfg Lwr	RL 25336-27000	5.43	
6 Blade, Fan	25321-20000	8.8	36.17
7 Shroud, Fan	25320-20000	8.8	71.26
8 Motor, Fan	25398-20000	8.8	159.94
Incl. R/Compl. w/Radiator Removed Duct 5			
9 Hose, Rad Upper	25411-29100	8.5	8.79
10 Hose, Rad Lower Man Trans	25412-29100	8.5	11.51
Auto Trans	25412-29170	8.5	14.37
Incl. R/Both 9			
11 Reservoir Assy, Coolant	25430-29100	4	10.97
12 Cap, Reservoir	25441-22020	1.07	
13 Gasket, Cap	25442-22000	8.8	34
14 Hose, Recovery	25443-29100	2.32	
Incl. w/Coolant Reservoir Assy			
15 Hose, Overflow	25451-29150	2.37	
16 Hose, Reserve	25452-29150	2.37	
17 Hose, Auto Trans Cooler	25453-29100	40.20	29.2

Illustration Located in Next Column

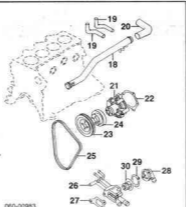

20 Hose, Water Inlet	25472-23000	7.89	
21 Pump, Water	25100-23000	m #1.9	66.39
1997-98			
	25100-23002	m #1.9	61.89
To 3-15-99			
	25100-23011	m #1.9	61.89
Per AC Add. 2			
22 Gasket, Pump	25124-23000	1	3.36
23 Pulley, Pump Drive	25221-20000	m	27.6
24 Pulley, Per Strg Drive	25226-23000	10.32	
1997-98			
	25226-23000	10.32	
From 9-10-99			
	25226-23000	10.32	
25 Belt, Pump/Alternator	25212-23000	8.8	10.94
26 Gasket, Housing	25614-23000	8.8	2.76
27 Gasket, Housing	25614-23000	8.8	2.76
Incl. R/Compl. Includes R/R Thermostat, Gasket & Cover			
28 Cover, Thermostat	25631-23001	8.6	8.51
29 Gasket, Cover	25633-23000	8.8	1.86
30 Thermostat	25500-23000	8.6	11.29
Incl. R/Compl. w/ AC Add. 1			

AC/REFRIGERANT CAPACITIES

AC R-134a Refrigerant Capacity	
1997-99: 24-26 Ccu (1.50-1.61 Lbs.)	

AC/HEATER

Use Procedure Explanation 6 with the following test.

Evacuate & Recharge System	m	1.4
Recover Refrigerant	m	3

NOTE: R/R Does Not include recover, evacuate and recharge system.

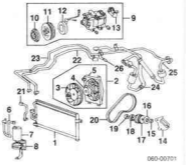

1 Condenser			
1997			
	To 4-17-97	97806-27000	m #1.0 341.09
From 4-17-97			
		97806-27060	m #1.0 341.09
1998-99			
		97806-27050	m #1.0 341.99
2 Fan & Motor Assy, Condenser	97730-20060	5	222.91
3 Blade, Fan	97733-20000	8.8	24.71
4 Motor, Fan	97786-20000	8.8	152.21
5 Shroud, Fan	97735-20060	8.8	48.97
Incl. w/Condenser Fan & Motor Assy			
Incl. R/Compl. w/Radiator Removed Duct 3			
6 Pipe, Used	97788-27000	m	33.03
7 Receiver/Drier	97801-20000	m	90.42
8 Bracket, Receiver/Drier	97851-27000	m	10.99
9 Compressor Assy			

1997			
	To 6-13-97	97701-20000	m 5 698.87
From 6-13-97			
		97701-27000	m 5 577.77
1998-99			
		97701-27000	m 5 577.77
		97644-20000	m #1.0 73.70
10 Clutch, Compressor Pulley, Compressor			
1997			
	To 6-13-97	97643-20000	m #1.0 46.34
From 6-13-97			
		97643-27000	m 5 38.81
1998-99			
		97643-27000	m #1.0 45.90
12 Coil, Compressor			
Incl. R/Compl.			
13 Manifold, Compressor			
1997			
	To 6-13-97	97717-20000	m 52.23
From 6-13-97			
		97717-22000	m 48.54
1998-99			
		97717-22000	m 48.54
Incl. w/Compressor Assy			
14 Bracket, Tension Pulley	97702-20000	m	51.92
15 Spacer	97830-20000	m	1.51
16 Cover, Dust	97833-22000	m	4.29
17 Pulley, Idler	97834-29010	m	42.80
18 Cover, Dust	97833-20500	m	4.29
19 Nut, Pulley	13095-10001	m	.26
20 Belt, A/C	97713-20000	s	21.31
21 Tube, Condenser			
1997			
	To 4-17-97	97761-27000	m #1.9 36.65
From 4-17-97 Serviced w/Condenser			
1998-99 Serviced w/Condenser			
		97766-20000	m #1.0 90.32
22 Pipe, Discharge Tube, Liquid	97759-20002	m #1.0	33.03
24 Hose, Discharge			
1997			
	To 3-15-97	97762-29150	m #1.0 106.10
From 3-15-97			
		97762-27500	m #1.0 81.17
1998-99			
		97762-27500	m #1.0 81.17
25 Hose, Suction			
1997			
	To 6-13-97	97763-29100	m #1.0 116.95
From 6-13-97			
		97763-27000	m #1.0 108.16
1998-99			
		97763-29100	m #1.0 116.95
Incl. w/Additional 5			
26 Bracket, Tube Mfg	97761-29100	m	2.95

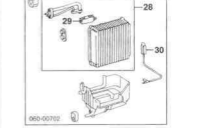

27 Evaporator Assy	97801-29001	m #5.0	446.77
1996			
	To 4-30-96	97801-29001	m #5.0 446.77
From 4-30-96			
		97801-29001	m #5.0 446.77
1997			
	To 9-30-99	97801-29002	m #5.0 446.77
From 9-30-99			
		97801-29002	m #5.0 446.77
28 Core Assy, Evaporator	97804-29000	m #5.3	384.05
1997-98			
	To 9-30-98	97804-29000	m #5.3 384.05
From 9-30-98			
		97804-29001	m #5.3 384.05
29 Valve, Expansion (A)	97826-29000	m #5.3	86.61
1999			
	To 9-30-98	97826-29000	m #5.3 86.61
From 9-30-98			
		97826-29002	m #5.3 86.61
(A) Incl. w/Evaporator Core Assy			
(B) Incl. w/Instrument Panel			
30 Thermostat, Temp	97806-29000	m	37.67
Incl. w/Evaporator Assy			

Illustration Located in Next Column

31 Heater Assy	97200-29000	m #4.0	132.23
32 Core, Heater	97202-29001	m	44.3
Incl. w/Instrument Panel, Incl. w/R Evaporator Assy or Evaporator Core, w/ AC Add. 1.0			
33 Cover, Heater Core	97214-20000	m	6.02
Incl. w/Heater Assy			
34 Hose, Heater Outlet	97319-29110	m	7.37

HYUNDAI TIBURON 1997-99

A/C HEATER Cont'd

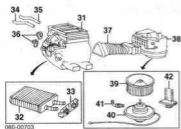

35 Hose, Heater Inlet	97318-29100	m	6.54
36 Grommet, Hose (4)	14720-21008-B	m	8.8
37 Duct, Heater Blower	97245-29000	m	13.42
38 Blower Assy	97100-29001	m	44.0 271.36
<i>Includes R&R Instrument Panel, w/ A/C Add 1.0 Included in R&R Evaporator Assy, Cond. Expansion Valve, Heater Assy & Heater Core</i>			
39 Fan, Blower ¹	97117-29000	m	18.99
40 Motor, Fan ²	97116-24955	m	5 146.80
41 Hose, Motor Cooling ³	97121-24000	m	5.17
42 Resistor, Fan Motor ⁴	97035-29000	m	30.41
<i>Included w/ Blower Assy</i>			



43 Control Assy, Heater w/ A/C	97250-27000	m	215.26
44 Switch, Recirculation ¹	97250-27050	m	190.56
45 Switch, Blower ²	97271-27000	m	47.49
46 Cover, A/C Switch ³	97274-27000	m	29.92
47 Switch, A/C ⁴	97265-27000	m	23.75
48 Knob, Blower Switch ⁵	97264-27000	m	25.75
49 Knob, Motor ⁶	97273-27000	m	5.69
50 Knob, Temp Control ⁷	97278-27000	m	5.49
51 Switch, Temp ⁸	97267-29000	m	11.41
52 Cable, Temp Control ⁹	97276-27000	m	23.97
53 Switch, Motor ¹⁰	97266-27000	m	5.99
54 Harness & Block ¹¹	97275-27000	m	9.35
55 Wiring Assy, Heater Control ¹²	97266-27000	m	17.83
56 Button ¹³ (a) (2)	97322-33700	m	2.58
<i>Included w/ Heater Control Assy</i>			
<i>(a) Included w/ Heater Control Wiring Assy</i>			

FRONT FENDER

Use Procedure Explanations 7 and 28 with the following list.

Refinish Fender Outside	RL	#1.8
Add to Edge Fender	RL	#5
R&R Fender Assy	RL	#1.2
<i>Includes R&R/R Park/Signal Lamp Assy & Fender Liner</i>		

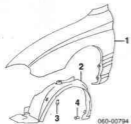

1 Panel, Fender	R 96320-27000 L 96319-27000	#1.4 #1.4	192.29 192.29
<i>Includes R&R/R Park/Signal Lamp Assy & Fender Liner</i>			
2 Liner, Fender	R 96813-27000 L 96811-27000	#3	41.50 41.50
3 Retainer, Front/Center			

(2/Size)	RL 96390-28000 RL 96848-22000	1.50 30
----------	----------------------------------	------------

UNDERHOOD DIMENSIONS

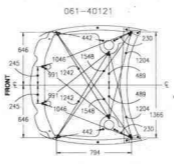

FRONT INNER STRUCTURE

Use Procedure Explanations 8 and 28 with the following list.

Refinish Radiator Support	RL	1.5
Add to R&R Radiator Support	RL	8.4
<i>To R&R/R Base Model Mechanical Components</i>		
<i>Includes R&R/R Power Steering Oil Cooler Tube w/ A/C</i>		
<i>Includes R&R A/C Condenser & Receiver/Drier w/ Auto Trans</i>		
To Air Lamps	RL	2
Evacuate & Recharge System	RL	1.4
Recover Refrigerant	RL	3

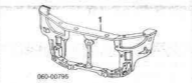

1 Support, Radiator	64100-27010	#7.3	243.63
<i>Includes R&R/R Hi-Lamp Assembly, Park/Signal Lamp Assemblies, Radiator, Fan Blade, Shroud & Motor as an Assy, Battery, Air Cleaner Air Duct, Windshield Washer Assy, Hood Latch, Prop Rod & Disconnect & Connect Hood Release Cable Wiring & Harness</i>			

SIDE

Refinish Apron Panel	RL	1.0
Refinish Side Rail	RL	1.0

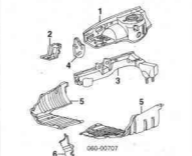

1 Panel, Apron	R 94920-27012 L 94910-27011	#7.5 #7.5	294.59 294.59
<i>Includes Radiator Support Removed Deduct 1.5</i>			
2 Bracket, Fender	R 94933-27000 L 94581-27000		3.40 3.40
3 Rail, Side	R 94920-27011	#9.0	543.34

#/Part Panel Removed Deduct 3.5	L 94801-27010	#9.0	540.34
---------------------------------	---------------	------	--------

4 Hook, Tow	R 94823-29000 L 94819-29000		7.09 7.09
5 Cover, Engine Under	R 29120-29001 L 29120-29010		31.33 31.33
6 Guard, Rad Left Side	R 96365-27000		9.27

ELECTRICAL COMPONENTS

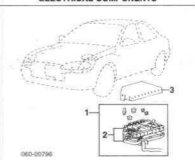

1 Wiring Fuse Box Assy	91200-27000	m	510.25
<i>Main Trans</i>			
1997	91200-27000	m	510.25
1998	91200-27000	m	510.25
To 9-18-97	N.A.	m	0.00
From 9-18-97 to 5-13-98	N.A.	m	0.00
From 5-13-98	N.A.	m	0.00
1999	91200-27000	m	473.89
w/ A/C	91200-27000	m	473.89
To 9-18-97	91200-27000	m	473.89
From 9-18-97 to 5-13-98	91201-27200	m	473.89
From 5-13-98	91201-27211	m	473.89
1999	91201-27211	m	473.89
<i>Auto Trans</i>			
w/ A/C	91200-27000	m	718.22
1997	91200-27000	m	718.22
1998	91200-27000	m	718.22
To 9-18-97	N.A.	m	0.00
From 9-18-97 to 5-13-98	N.A.	m	0.00
From 5-13-98	N.A.	m	0.00
1999	91200-27010	m	754.01
w/ A/C	91200-27010	m	754.01
1997	91200-27010	m	754.01
1998	91200-27010	m	754.01
To 9-18-97	91200-27010	m	754.01
From 9-18-97 to 5-13-98	91201-27211	m	754.01
From 5-13-98	91201-27211	m	754.01
1999	91201-27211	m	754.01
2 Box, Relay & Fuse ¹	91943-27000	m	74.00
<i>Included w/ Wiring Fuse Box Assy</i>			
3 Cover, Box Upper	91215-27100		7.31
1997-98	91215-27100		7.31
To 9-31-96	91213-27100		7.31
From 9-31-96	91213-27101		7.31

AIR BAG SYSTEM

Disable & Enable Air Bag System	m	3
Diagnose Air Bag System (If Required)	m	8.5
<i>Includes Disconnect & Connect Scan Tool & Retrieve/Clear Trouble Codes</i>		

NOTE 1: R&R Does Not include disable and enable or diagnose Air Bag System.
NOTE 2: Refer to Procedural Explanation 30 for Supplemental Restraint/Air Bag System Component Installation and Replacement Information.

NOTE 3: For Air Bag System Service procedures, refer to Manufacturer's Service Repair Manual or Mitchell's Air Bag Service and Repair Manual.

Illustration Located in Next Column

1 Module Assy, Driver Air Bag	56900-29110	m	3 622.26
2 Button, Horn ¹	R 95913-29110 L 95912-29110	m	12.26 12.26
<i>Included w/ Driver Air Bag Module Assy</i>			
3 Module, Pass Air Bag	94530-27000	m	#3.7 647.99
<i>Includes R&R Instrument Panel</i>			
4 Cover, Air Bag Module			
1997	94531-27000-LK	m	255.64
To 2-24-97	94531-27010-LK	m	262.87
1998	94531-27010-LK	m	262.87
To 10-1-97	94531-27010-LK	m	262.87
From 10-1-97	94531-27000-LK	m	255.64
1999	94531-27000-LK	m	255.64

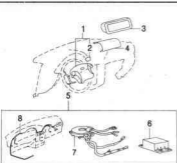

5 Service Kit, Air Bag Module, Control	92990-27001	m	490.00
6 Screw, Control Module(s) (A) Air Required	95110-27400	m	365.00
	N.A.	m	0.00
7 Cookspring	93490-29004	m	122.34
8 Harness, Wiring (Includes w/Air Bag Service Kit)	91700-27000	m	130.48

ABS/BRAKES

Bleed System..... m 5

NOTE: R/R Does Not include bleed brake system.

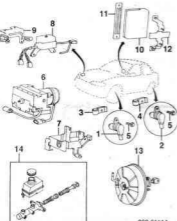

1 Sensor, ABS Front	R 95675-29500	m	#8	116.54
	L 95670-29500	m	#8	119.74
2 Sensor, ABS Rear	R 95680-27500	m	#6	110.46
	L 95680-27500	m	#6	110.46
1999	R 95685-27500	m	#6	110.46
	L 95680-27500	m	#6	110.46
From 10-12-98	R 95655-27501	m	#6	110.46
	L 95660-27501	m	#6	110.46
3 Clamp, Fit Sensor Wire	R/L 95689-36000	m	43	
4 Clamp, Rear Sensor Wire	R/L 95689-35000	m	43	
5 Bolt, Sensor	R/L 11230-08161	m	.22	
6 Module, Hydraulic	98110-29000	m	1.3	1317.69
1997				
To 8-11-97	98110-29000	m	1.3	1317.69
From 8-11-97	98110-29010	m	1.3	1317.69
1999				
To 8-31-98	98110-29010	m	1.3	1317.69
From 8-31-98	98110-29000	m	1.3	0.00
7 Bracket, Module	98060-29010	m	22.32	
1997-98				
To 8-31-98	95990-29010	m	22.32	
From 8-31-98	98060-29000	m	28.75	
8 Retray, ABS	95991-29500	m	5	223.08
9 Bracket, ABS Relay	95991-29000	m	5.25	
10 Module, ABS Control	95991-29000	m	6	630.77
11 Brake, Module Upper	95951-29000	m	3.00	
12 Brake, Module Lower	95952-29000	m	3.38	
13 Booster, Brake	99110-27001	m	#12	418.52

Includes R/R Brake Master Cylinder

14 Cylinder, Brake Master				
w/ABS	98510-29010	m	J	285.51
1999				
To 8-31-98	98510-29010	m	J	285.51
From 8-31-98	98510-29015	m	J	118.26
w/o ABS	98510-29010	m	J	233.75

CRUISE CONTROL SYSTEM

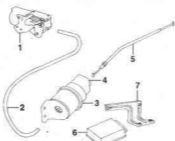

1 Pump, Cruise	96420-29000	m	5	125.53
2 Inlet, Pump	17300-29000	m	5	58.46
3 Actuator, Cruise	96440-29000	m	5	41.75
4 Cover, Actuator	96448-34000	m	5	1.21
5 Cable, Cruise Control	96430-29000	m	5	19.35
Module, Cruise Control				
Man Trans	96410-29650	m	8	236.30
Auto Trans				
1.5L Eng	96410-29750	m	8	219.57
2.0L Eng				
1997				
To 7-1-97	96410-29750	m	8	219.57
From 7-1-97	96410-27100	m	8	236.30
1998-99	96410-27100	m	8	236.30
7 Bracket, Module	96411-27000	m	2	2.77

WHEEL

Use Procedure Explanation 10 with the following text.

STEEL WHEEL

Retain Wheel	5
Add to R/R Spare Wheel & Tire Assy	2

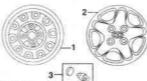

1 Wheel, Steel	52910-29400	3	125.12
2 Cover, Wheel Full	92960-27000	m	50.42
3 Nut, Lug	92950-24000	m	4.38
Stem, Valve	N.A.	m	0.00

ALUMINUM WHEEL

Add to R/R Spare Wheel & Tire Assy..... 2

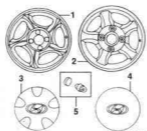

Wheel, Aluminum	1 14x5-112	3	179.89
	2 14x6"	3	172.51
	3 14x7"	3	172.51
Cap, Center	52910-32000	3	179.89
	52910-27000	3	172.51
14x5-112" Wheels	52960-32000	10	02

4 15x6" Wheels	52960-27000	28	53
5 Nut, Lug	92961-11210	1	48
Stem, Valve	N.A.	m	0.00

FRONT SUSPENSION

Use Procedure Explanation 11 with the following text.

R/R Suspension (One Side)	R/Lm	1.5
OH Suspension (Includes R/R)	R/Lm	2.5
One Side	R/Lm	2.5
Both Sides	R/Lm	4.8
Adjust Four Wheel Alignment	m	1.0
Bleed Brake System	m	5
w/o ABS	m	3

NOTE 1: R/R/R/R or OH Does Not include alignment or bleed brake system.
NOTE 2: All Parts in this section are included in overhaul unless noted otherwise.

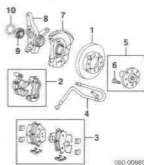

1 Rotax, Brake	1997-98	R/L 51712-09000	m	#1.8	68.92
	1999	R/L 51712-09010	m	#1.8	68.92
	To 8-16-98	R/L 51712-09100	m	#1.8	68.92
	From 8-16-98	R/L 51712-09110	m	#1.8	69.23
		Includes in R/R Knuckle, R/R Both Sides 3,4			
2 Caliper, Brake	1997-98	R 58190-29A20	m	4.5	184.82
		L 58190-29A20	m	4.5	184.82
	1999	R 58190-29A20	m	4.5	184.82
	To 8-31-98	R 58190-29A20	m	4.5	184.82
	From 8-31-98	R 58190-29A20	m	4.5	184.82
		Includes Hub or Rotor Removed Deduct 3, R/R Both Sides 8			
3 Pad Set, Brake	1997-98	58101-29A31	m	#1.0	43.08
	1999				
	To 8-31-98	58101-29A31	m	#1.0	43.08
	From 8-31-98	58101-29A70	m	#1.0	43.08
		Includes Caliper Removed Deduct 5			
4 Hose, Brake	1997-98	R 58732-29010	m	4.3	37.84
		L 58731-29010	m	4.3	37.84
		Includes Caliper Removed Deduct 2			

5 Sensor, Front ABS-See ABS/Brakes Section					
6 Hub Assy, Wheel	1997-98	R/L 51750-29000	m	#1.8	105.26
	1999	R/L 51750-29000	m	#1.8	105.26
	To 9-3-98	R/L 51750-29000	m	#1.8	105.26
	From 9-3-98	R/L 51750-29100	m	#1.8	97.11
7 Stud, Wheel(s) (4/Side)	R/L 51742-11120	m	1.52		
	Includes w/Wheel Hub Assy				
8 Plate, Steering	R 51735-29000	m	#1.8	15.24	
	L 51735-29000	m	#1.8	15.24	
9 Knuckle, Shocking w/ABS	R 51716-29100	m	#1.8	218.80	
	L 51715-29100	m	#1.8	218.80	
	w/o ABS	R 51716-29000	m	#1.8	218.80
		L 51715-29000	m	#1.8	218.80
9 Bearing, Wheel(s)	R/L 51720-29000	m	#1.8	86.15	
10 Ring, Snap	Includes by Application	R 51716-29100	m	#1.8	10.05
		Includes R/R Side Complete, Includes R/R Rotor, R/R Both Sides 3,4			

Illustration Located in Next Column

11 Arm Assy, Lower Control	R 54501-29000	m	#8	156.17
	R/L 54500-29000	m	#8	156.17
	Includes R/R Both Sides 1,4, Knuckle Removed Deduct 7			
12 Bushing, Arm Front	R/L 54551-29000	m	1.0	12.11
13 Bracket, Arm Mtg	R 54584-29000	m	22.51	
	R/L 54583-29000	m	22.51	
14 Ball Joint Assy, Lower	R/L 51715-29000	m	8	22.36
	R/L 51715-29000	m	8	22.36
15 Nut, Lock(s) (a)	R/L 13262-12001	m	43	
16 Cover, Dust(s) (a)	R/L 54517-22000	m	4.08	

2 D.L. Eng	5721-29410	m	5	6.09
6 Hose, Pressure	57510-29100	m	8	121.83
7 Pipe & Hose Assy, Return				
1997	57560-29010	m	30.55	
To 3-20-98	57560-29010	m	1.1	30.55
From 3-20-98	57560-29000	m	1.1	30.55
1999	57600-29020	m	1.1	30.55
8 Hose, Return	57560-29000	m	1.1	11.53
Included w/Return Pipe & Hose Assy				
9 Pipe & Hose Assy, Fluid	57070-29010	m	33.38	
10 Hose, Fluid	57310-29010	m	12.78	
Included w/Fluid Pipe & Hose Assy				
11 Bracket, Pressure Hose				
1997				
To 11-5-96	57261-29001	m	5.29	
From 11-5-96	57261-29000	m	5.70	
1999-99	57261-29002	m	5.70	
12 Clip, Pressure Pipe Mtg	57265-29010	m	7.32	
13 Stay, Fluid Pipe	57210-29001	m	1.58	
14 Clip, Fluid Pipe Mtg	57210-29000	m	4.18	
15 Hose, Suction	57310-29010	m	5	15.11
16 Reservoir Assy, Fluid	57336-29000	m	5	19.09
1997				
To 9-18-96	57150-29010	m	57.82	
From 9-18-96	57150-29014	m	57.82	
1999-99	57150-29001	m	57.82	
19 Cap, Reservoir	57153-34003	m	6.37	
Included w/Fluid Reservoir Assy				
19 Bracket, Reservoir	57220-29002	m	6.19	
20 Tube, Oil				
1997-98	57540-27000	m	1.3	59.69
1999				
To 11-2-98	57540-27000	m	1.3	59.69
From 11-2-98	57540-27020	m	1.3	59.69

6 Clackring-Seal Air Bag System Section				
Switch Assy, Combination				
1.8L Eng	93450-27151	m	1.4	164.74
w/ Cruise Control	93450-27101	m	1.4	144.18
2.0L Eng				
w/ Cruise Control	93450-27181	m	1.4	175.38
w/ Eled Control	93450-27151	m	1.4	175.38
w/ Cruise Control	93450-27111	m	1.4	166.54
w/ Eled Control	93450-27101	m	1.4	144.18
8 Cam, Camshaft	93440-34000	m	2.86	
9 Switch, Wiper/Washer				
1.8L Eng	93430-27152	m	1.4	52.96
w/ Cruise Control	93430-27102	m	1.4	48.27
2.0L Eng				
w/ Cruise Control	93430-27162	m	1.4	58.35
w/ Eled Control	93430-27152	m	1.4	52.86
w/ Cruise Control	93430-27112	m	1.4	47.15
w/ Eled Control	93430-27102	m	1.4	46.35
10 Switch, Light/Signal	93415-27110	m	1.4	61.05
11 Sensor, Velocity				
Included w/Combination Switch Assy	93480-27000	m	1.4	53.80
12 Switch Assy, Ignition				
Man Trans	81900-29001	m	9	177.90
Auto Trans	81900-29001	m	9	189.64
13 Switch, Ignition	80110-25000	m	9	11.86
14 Solenoid & Switch, Ignition	85412-29100	m	24.22	
Included w/ignition Switch Assy				

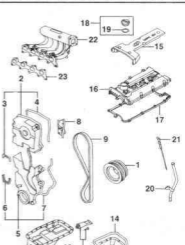

STEERING WHEEL/COLUMN

R&I Steering Column	m	1.5
O/H Steering Column (Includes R&I)	m	2.5

NOTE: All Parts in this section are included in overhaul unless noted otherwise.



1 Wheel, Steering				
Vinyl	56100-29600	m	5	251.79
Leather	56100-29600	m	5	891.51
2 Module Assy, Driver Air Bag-See Air Bag System Section				
1997				
To 4-7-97	84851-27100	m	4.3	28.96
From 4-7-97	84851-27100-KW	m	4.3	28.96
1999-99	84851-27100-KW	m	4.3	28.96
4 Cover Assy, Column Lower				
1997				
To 4-7-97	84852-27100	m	4.3	39.71
From 4-7-97	84852-27100-KW	m	4.3	39.71
1999-99	84852-27100-KW	m	4.3	39.71
#R&I Complete				
5 Grommet, Lwr Cover	84853-30000	m	3.26	
Included w/Column Lower Cover Assy				

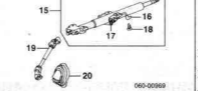
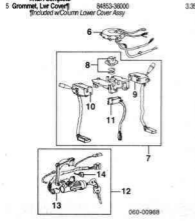

15 Column & Shaft Assy, Steering	50300-27000	m	2.5	445.14
16 Lwr. Thr.†				
1997				
To 10-10-96	96338-27500	m	2.5	12.67
From 10-10-96	96338-27502	m	2.5	12.67
1999-99	96338-27502	m	2.5	12.67
17 Spring, Lower†	14814-25000	m	2.5	2.35
Included w/Steering Column & Shaft Assy				
19 Joint, Universal	56400-27500	m	1.5	257.11
20 Cover, Dust	96250-29000	m	1.5	30.18

ENGINE/TRANS

Use Procedure Explanation 12 with the following text.

R&I Engine/Trans Assy				
Man Trans	m	6.2		
Auto Trans	m	6.7		
Add to R&I Engine/Trans Assy				
w/ AC	m	8		

†Illustration Located in Next Column

1 Pulley, Crankshaft	23124-23010	m	4.7	121.72
2 Cover Assy, Upper Timing				
1.8L Eng	21360-23000	m	4	30.87
2.0L Eng	21360-23000	m	4	30.98
3 Gasket, Uppr Timing Cover†				
Front	21362-23000	m	1.15	
4 Gasket, Uppr Timing Cover†				
Rear				
1.8L Eng	21363-23001	m	2.29	
2.0L Eng	21363-23001	m	2.29	
Included w/Upper Timing Cover Assy				
5 Cover Assy, Lower Timing	21360-23000	m	4.7	30.87
Includes R&I/R&R Upper Cover and Crankshaft Pulley, w/ AC				
Add 2				
6 Gasket, Lower Timing Cover†	21362-23000	m	1.15	
7 Gasket, Lower Timing Cover†				
Rear	21363-23001	m	2.57	
Included w/Lower Timing Cover Assy				
8 Cover, Rear Timing	21371-23000	m	8.54	
9 Belt, Timing				
1.8L Eng	24312-23001	m	43.0	59.54
2.0L Eng	24312-23001	m	43.0	59.54
#w/ AC Add 2				
10 Pin, Eng Oil	21510-23030	m	1.9	104.33
11 Stay, Eng Oil Pan	21471-23000	m	75.62	
12 Sealant, Eng Oil Pan	3004-C-33040	m	0.20	
13 Pin, Trans Oil	45286-29000	m	1.0	69.91
14 Gasket, Trans Oil Pan	45285-29010	m	9.00	
15 Cover, Center				

1.8L Eng	22405-23004	m	2	20.60
2.0L Eng	22405-23020	m	2	20.60
16 Cover, Valve	230410-23010	m	8.5	227.96
17 Gasket, Valve Cover	23441-23000	m	8.5	18.91
Includes R&R Center Cover				
18 Cap Assy, Oil Filter	26510-26003	m	1.5	15.15
19 Seal, Oil Filter Cap†	26502-11510	m	1.5	2.10
Included w/Oil Filter Cap Assy				
20 Tube, Engine Dipstick				
1997-98	26612-23001	m	5	9.85
To 5-1-99	26612-23001	m	5	9.85
From 5-1-99	26612-23001	m	5	9.85
21 Dipstick, Engine Oil	26611-23010	m	4.36	
22 Manifold, Intake	26310-23005	m	42.7	295.52
23 Gasket, Intake Manifold	28411-23001	m	42.7	10.69
#R&I Complete				

ENGINE/TRANS MOUNTS

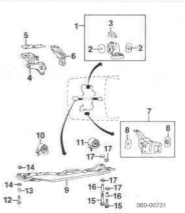

1 Mount Assy, Engine Side	21810-29100	m	7	143.57
Man Trans	21810-29100	m	7	143.57
Auto Trans	21810-29150	m	7	143.57
1997-98	21810-29150	m	7	143.57
1999	21810-29150	m	7	143.57
To 1-14-99	21810-29100	m	7	143.57
From 1-14-99	21810-29100	m	7	143.57
2 Plate, Mount Stop†(2)				
Man Trans	21814-28250	m	5.47	7.07
Auto Trans	21818-24000	m	5.47	7.07
3 Damper†	21817-29101	m	15.86	
Included w/Engine Side Mount Assy				
4 Bolt, Eng Supt Front	21670-23000	m	75.82	
5 Plate, Supt	21670-23001	m	5.84	
6 Bolt, Eng Supt Rear	21672-23000	m	20.66	
7 Bracket Assy, Trans axle Mounting				
Man Trans	21830-29100	m	8	99.96

HYUNDAI TIBURON 1997-99

ENGINE/TIBURON MOUNTS Cont'd

Auto Trans	21830-29150	J	102.72
8 Plate, Mount Stop ⁽²⁾			
Man Trans	21834-28000	J	5.35
Auto Trans	21834-29500	J	5.35
9 Crossmember, Eng	Included w/Transaxle Mounting Bracket Assy	m	151.96
21700-29000			
10 Bolt, Front Roll Stop			
Man Trans	21910-29001	J	57.36
Auto Trans	21910-29051	J	58.03
1997-98			
To 1-14-99	21910-29051	J	58.03
From 1-14-99	21910-29500	J	58.06
11 Bolt, Rear Roll Stop			
Man Trans	21930-29000	J	52.85
Auto Trans	21930-29050	J	52.85
1997-98			
To 1-14-99	21930-29050	J	52.85
From 1-14-99	21930-29510	J	54.30
12 Bolt, Crossmember Frt (2)	21722-24000	J	5.44
13 Collar, Front Bolt (2)	21721-24000	J	2.72
14 Bushing, Front (4)	21725-24000	J	3.37
15 Bolt, Crossmember Rear	R 21726-28000	J	5.43
	L 21726-24000	J	5.43
16 Collar, Rear Bolt	R 21725-24000	J	2.72
	L 21724-24000	J	3.37
17 Bushing, Rear (4)	21724-24000	J	3.37

AIR CLEANER

R&I Air Cleaner Assy

A

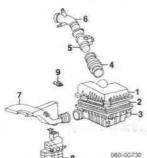

060-00732

1 Cover, Air Cleaner	28111-23003	J	28.15
2 Element, Cleaner	28113-23001	J	13.96
3 Housing, Cleaner	28112-23002	J	38.30
4 Hose, Air Intake	28138-23001	J	22.63
5 Sensor, Air Flow	28164-23000	m	253.86
6 Hose, Throttle Intake	28139-23002	J	43.62
7 Duct, Air	28210-23002	J	22.85
8 Resonator	28190-23002	J	16.89
9 Sensor, Temp	39340-23000	m	8.96

EXHAUST

1.8L ENG

R&I Exhaust System Complete

#Does Not Include R&I Exhaust Manifold

#1.0

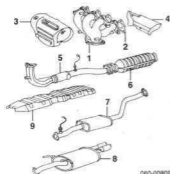

060-00809

1 Manifold, Exhaust	97-98 28511-23052	m	J	282.96
	99 28511-23002	m	J	177.24
2 Gasket, Manifold	28521-23004	m	J	11.54

Front	28625-29052			22.56
4 Shield, Manifold Heat				
Rear	97-98 28528-23051			12.72
	99 28528-23000			10.16
5 Pipe, Front Exhaust	28600-29052	J	J	163.34
6 Converter, Catalytic	28950-23070	J	J	563.53
7 Pipe, Center Exhaust	28655-27067	J	J	208.50
8 Muffler & Tailpipe	26700-27051	J	J	243.90
9 Panel, Heat Protector Ctr	28798-29000			39.40

2.0L ENG

R&I Exhaust System Complete

#1.0

#Does Not Include R&I Exhaust Manifold

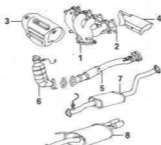

060-00810

1 Manifold, Exhaust	28511-23002	m	J	177.24
2 Gasket, Manifold	28521-23004	J	J	11.54
3 Shield, Frt Manifold Heat	28528-23051	J	J	22.84
4 Shield, Rear Manifold Heat	28528-23000	J	J	10.16
5 Pipe, Front Exhaust	28610-29752	J	J	160.36
6 Converter, Catalytic	Included w/ Application			
7 Pipe, Center Exhaust	28950-23400	J	J	525.04
8 Muffler & Tailpipe	28650-27059	J	J	198.56
	28790-27051	J	J	243.90

EMISSION SYSTEM



060-00811

1 Canister, Vapor	31420-29000	m	J	86.22
2 Bolt, Canister Mtg	31450-29000	m	J	5.80
3 Supp, Canister Bolt	31461-29000	m	J	1.66
4 Valve, Canister	31430-29000	m	J	48.22
5 Tube, Canister Vent	31456-29010	m	J	4.80
6 Valve, 2-Way	31135-29000	m	J	14.22

ELECTRICAL

ALTERNATOR

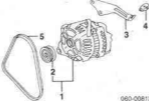

060-00812

1 Alternator Assy	37300-22200	m	J	263.64
2 Pulley, Alternator ⁽¹⁾				
1997	37321-22200	J	J	16.51
1998-99	37321-22210	J	J	16.51
3 Bracket, Alternator	37461-23001	J	J	3.03
4 Nut, Alternator Adj	37463-33000	J	J	4.62
5 Belt, Drive	25212-23000	J	J	10.94

BATTERY



060-00627

1 Battery (56 Amp Hours)	37110-1C200	J	J	73.08
2 Tray, Battery	37150-29110	J	J	16.56
3 Bracket, Battery Mtg	37166-29000	J	J	2.81
4 Cable, Battery	37200-27000	J	J	40.82
5 Cover, Pos Terminal	37257-23001	J	J	1.95

HORN

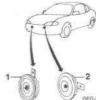

060-01013

1 Horn, High Note	96620-23051	J	J	40.96
2 Horn, Low Note	96610-29000	J	J	39.21

IGNITION

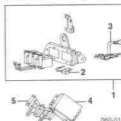

060-01014

1 Coil Assy, Ignition	27201-23003	m	J	72.45
2 Condenser, Ignition Coil ⁽¹⁾	27205-29010	m	J	6.15
3 Harness, Coil ⁽¹⁾	27067-23000	m	J	11.42
	Included w/ Ignition Coil Assy			
4 Computer, Main				
1.8L Eng	39110-29600	m	J	573.53
2.0L Eng	39110-29910	m	J	571.31
1997	39110-29900	m	J	602.08
1998				
To 1-14-99	39110-29955	m	J	573.54
From 1-14-99	39110-29931	m	J	601.29
5 Bracket, Computer	39112-23001	m	J	6.46
6 Wire Set, Ignition	27501-23400	m	J	48.66

STARTER

Starter	36100-22100	m	J	330.40
Man Trans	36100-23000	m	J	311.41
Auto Trans				

WINDSHIELD

Use Procedure Explanation 13 with the following text.

R/R Windshield Glass
Includes Clean Up Old Adhesive as Necessary



1 Glass Assy, Windshield Hyundai		#2.8	
Base Model	R 86110-2700	#2.5	344.72
FX Model	R 86110-2710	#2.5	360.21
NACS			
Green	FW0204G7GN	#2.5	619.40
Blue Blue Shade	FW0204R8BN	#2.5	626.96
Green/Blue Shade	FW0204G2BN	#2.5	626.90
Includes Clean Up Old Adhesive as Necessary			
2 Base, Mirror Mount	R 86115-2000		21.98
3 Pad, Spacer	R 86114-2700		1.40
Includes Windshield Glass Assy			
4 Spacer, Glass Lev	R 86122-2800		3.54
5 Dam, Windshield	R 86121-2840		20.40
6 Mounting, Reveal	R 86129-2700		17.92
7 Heating, Air, Windshield Garnish	R 86820-2700-LK		27.08
	R 86810-2700-LK		27.08
	R 86820-2700		91
8 Clip, Garnish	Included w/Windshield Garnish Mounting Assy		
9 Mirror, Rear View w/Sunroof	R 86101-2700		21.40
1997			
To 2-24-97	R 86203-2701-LK		75.96
	L 86201-2701-LK		69.00
From 2-24-97	R 86203-2700-LK		75.96
	L 86201-2700-LK		69.00
1998-99	R 86203-2700-LK		75.96
	L 86201-2700-LK		69.00
w/o Sunroof			
To 2-24-97	R 86202-27800-LK		75.96
	L 86201-27800-LK		66.01
From 2-24-97	R 86202-27800-LK		75.96
	L 86201-27800-LK		66.01
1998-99	R 86202-27800-LK		75.96
	L 86201-27800-LK		66.01
Retainer, Sun View w/Sunroof			
1997			
To 2-24-97	R 86205-2705-LK		2.45
From 2-24-97	R 86206-2705-LK		2.45
1998-99	R 86205-2705-LK		2.45
w/o Sunroof	R 86206-2705-LK		2.45

WIPER SYSTEM

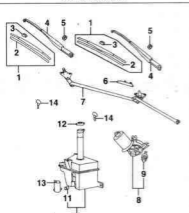

1 Blade Assy, Wiper	R 96350-2410		11.00
	R 96350-2700		11.33
2 Insert, Blade	R 96351-2700		6.32
	R 96351-2700		6.32
3 Clip, Blade Insert	R 96356-2400		1.18
Included w/Wiper Blade Assy			
4 Arm, Wiper		#2	35.78
1997			
To 1-7-97	R 96320-2700		

From 1-7-97	L 96310-2700	#2	35.78
	R 96320-2700	#2	35.78
	L 96310-2710	#2	30.25
	R 96320-2710	#2	35.78
1998-99	L 96310-2710	#2	30.25
Includes R/R Blade & Insert			
5 Nut, Wiper Arm Cap	R 96248-2700		1.50
6 Pin, Wiper Arm	SP 96319-2000		6.25
7 Link, Wiper	96200-2700		67.61
8 Motor Assy, Wiper	96100-2500	#.6	110.18
9 Bolt & Nut, Motor Muff	96120-3400		13.86
Included w/Wiper Motor Assy			
10 Reservoir Assy, Washer w/Rear Wiper	96220-2710	#	32.82
	96220-2700	#	42.14
	96222-1420		.85
11 Grommet, Reservoir	Included w/Washer Reservoir Assy		
12 Cap, Reservoir	96223-2200		1.14
13 Motor & Pump	96510-3400	#.6	38.04
Included in R/R Reservoir			
14 Nozzle, Spray	R 96330-2700	#2	6.94
Included in R/R Hood			

COWL & DASH

Use Procedure Explanations 14 and 28 with the following text.

Refinish Cowl Top Panel			1.2
Diagram 1-10			
Diagram 11-19			
Diagram 20-26			
Diagram 27-31			
Diagram 32-38			
Diagram 39-45			
Diagram 46-51			
Diagram 52-58			
Diagram 59-65			
Diagram 66-72			
Diagram 73-79			
Diagram 80-86			
Diagram 87-93			
Diagram 94-100			
Diagram 101-107			
Diagram 108-114			
Diagram 115-121			
Diagram 122-128			
Diagram 129-135			
Diagram 136-142			
Diagram 143-149			
Diagram 150-156			
Diagram 157-163			
Diagram 164-170			
Diagram 171-177			
Diagram 178-184			
Diagram 185-191			
Diagram 192-198			
Diagram 199-205			
Diagram 206-212			
Diagram 213-219			
Diagram 220-226			
Diagram 227-233			
Diagram 234-240			
Diagram 241-247			
Diagram 248-254			
Diagram 255-261			
Diagram 262-268			
Diagram 269-275			
Diagram 276-282			
Diagram 283-289			
Diagram 290-296			
Diagram 297-303			
Diagram 304-310			
Diagram 311-317			
Diagram 318-324			
Diagram 325-331			
Diagram 332-338			
Diagram 339-345			
Diagram 346-352			
Diagram 353-359			
Diagram 360-366			
Diagram 367-373			
Diagram 374-380			
Diagram 381-387			
Diagram 388-394			
Diagram 395-401			
Diagram 402-408			
Diagram 409-415			
Diagram 416-422			
Diagram 423-429			
Diagram 430-436			
Diagram 437-443			
Diagram 444-450			
Diagram 451-457			
Diagram 458-464			
Diagram 465-471			
Diagram 472-478			
Diagram 479-485			
Diagram 486-492			
Diagram 493-499			
Diagram 500-506			
Diagram 507-513			
Diagram 514-520			
Diagram 521-527			
Diagram 528-534			
Diagram 535-541			
Diagram 542-548			
Diagram 549-555			
Diagram 556-562			
Diagram 563-569			
Diagram 570-576			
Diagram 577-583			
Diagram 584-590			
Diagram 591-597			
Diagram 598-604			
Diagram 605-611			
Diagram 612-618			
Diagram 619-625			
Diagram 626-632			
Diagram 633-639			
Diagram 640-646			
Diagram 647-653			
Diagram 654-660			
Diagram 661-667			

1 Cover Assy, Cowl Top	R 96160-2700	#.6	33.97
	L 96150-2700	#.6	33.97
w/R/R Complete, Includes R/R Wiper Arms			
2 Strip, Cowl Top	R 96153-2700		6.10
Included w/Cowl Top Cover Assy			
3 Retainer, Cowl Top Cover Muff	R 96155-2000		.88
4 Cover, Air Inlet Hole	R 96140-2700		7.09
5 Panel, Cowl Top	R 96703-2710	#.5	120.61
6 Panel, Cowl Side			
Outer Upper	R 96796-2710		23.79
Inner Upper	R 96759-2710		22.96
7 Panel, Cowl Side			
Inner Upper	R 96671-2710		34.95
Outer Upper	R 96751-2710		34.95
8 Crossmember, Cowl Panel, Dash-Not Serviced	96640-2700-D		154.95
9 Instrument, Dash Panel	R 96124-2700		132.78

INSTRUMENT PANEL

Use Procedure Explanation 14 with the following text.

R/R Instrument Panel		m	3.5
NOTE: All Parts in this section are included in R/R Instrument Panel unless noted otherwise.			
Illustration Located in Next Column			
1 Panel, Instrument	R 84710-2710-LK	m	6.0
	97480-2700		7.37
2 Nozzle, Ctr Air Vent (2)	R 97420-2700	#.3	20.00
3 Nozzle, Ctr Air Vent	R 97350-2700	#.3	24.51
4 Nozzle, Defroster	R 97390-2700	#.3	4.77
5 Nozzle, Side Defrost	R 97386-2700	#.3	4.77
6 Duct, Inst Pnl Ctr	R 97470-2700	#.3	21.89
Included w/Glove Box Panel Removal			
7 Cover, Defroster Nozzle	R 97476-2700-LK		6.28
	R 97475-2700-LK		6.28
8 Frame, Lower	R 96781-2700		47.21
9 Grom, Speaker	R 84716-2700-LK		14.32
	L 84715-2700-LK		14.32
10 Speaker, Stereo	R 96380-2700		18.89
	L 96310-2700		18.89

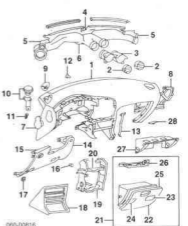

11 Grommet (4/Side)	R 14514-0500		36
12 Pin, Center Mty	R 84718-2700		1.46
13 Bar, Center Support	R 84789-2700		27.97
	L 84781-2700		27.97
14 Panel, Under	R 84780-2710-KW	#	111.87
15 Paint, Lower	84740-2700		106.64
16 Cover, Hole	84754-2700-KW		1.18
Includes Application			
17 Plate, Under Panel (2)	84837-3100		1.86
18 Panel, Center Finish			
1997			
To 4-7-97	R 84771-2700	#	61.05
From 4-7-97	R 84771-2700-KW	#	61.05
1998-99	R 84771-2700-KW	#	61.05
FX Moose w/Auto System w/CD Player			
1997			
To 4-7-97	R 84771-2700	#	53.93
From 4-7-97	R 84771-2700-KW	#	53.93
1998-99	R 84771-2700-KW	#	53.93
w/CD Player			
1997			
To 4-7-97	R 84771-2700	#	61.05
From 4-7-97	R 84771-2700-KW	#	61.05
1998-99	R 84771-2700-KW	#	61.05
w/Auto System			
19 Bracket, Center Supt	R 84730-2701		64.82
w/Auto System			
20 Bracket, Stereo Supt	R 84730-2701		64.92
21 Glove Box Assy	R 84730-2700		8.95
1997			
To 4-7-97	R 84810-2700-LK	#	152.50
From 4-7-97	R 84810-2700-KL	#	152.50
1998-99	R 84810-2700-LK	#	152.50
22 Cover, Glove Box	R 84512-2710-LK	#	36.77
23 Knob, Glove Box	R 84505-2710-LK	#	23.62
24 Label, Air Bag	R 84513-8250		4.40
25 Panel, Glove Box Infr-Serviced w/Glove Box Assy	R 84525-2700	#	19.51
26 Hinge, Glove Box	R 84525-2700	#	19.51
Included w/Glove Box Assy			
27 Cover, Glove Box Up	R 94541-2700-LK	#	26.97
28 Striker, Glove Box	R 91513-2700	#	4.31

060-00970

060-00816

060-00815

060-00814

060-00817

INSTRUMENT PANEL Cont'd

31 Holder, Wiring	87067-30300		1.17
32 Module, Passenger Air Bag-See Air Bag System Section			
33 Cover, Air Bag Module-See Air Bag System Section			
34 Ashtray			
Base Model			
1997			
To 4-7-97	84550-27000		64.42
From 4-7-97	84550-27000-KW		64.42
1998-99	84550-27000-KW		64.42
FX Model			
1997			
To 4-7-97	84550-27100		75.39
From 4-7-97	84550-27100-KW		75.39
1998-99	84550-27100-KW		75.39
35 Clock, Digital	84510-27000		112.82
36 Socket Assy, Cigarette Lighter (s)	85120-20000	3	22.51
37 Socket, Cigarette Lighter (s)	85140-24000	10	10.42
38 (Order by Application)			
39 Bulb(s)	18643-01004		75
40 Element, Cigarette Lighter(s)	85110-84001		12.71
Included w/Cigarette Lighter Socket Assy			
41 Holder, Cup(s)			
1997			
To 4-7-97	84790-27000		60.06
From 4-7-97	84790-27000-KW		60.06
1998-99	84790-27000-KW		60.06
(Order by Application)			
42 Tray, Center	NA		0.00
1997			
To 4-7-97	84776-27000		17.77
From 4-7-97	84776-27000-KW		17.77
1998-99	84776-27000-KW		17.77
43 Rheostat, Illum Control			
1997			
To 4-7-97	94950-27000		26.85
From 4-7-97	94950-27000-KW		26.85
1998-99	94950-27000-KW		26.85
44 Stereo Unit			
Cassette	97-66 86160-26510-FLT	6	365.00
CD Player	86180-23000-FLT	6	0.00
02021-18100-FLT		6	577.00
02021-18100-FLT		6	1275.00
45 Sensor, Speed	84620-27000	m	35.01
46 Glass, Cluster Meter	94300-27000	m	23.29
47 Bezel, Cluster Meter	94361-27000	m	8.94
48 Lens, Speed Symbol (2)	94366-27000	m	2.48
49 Gauge, Fuel & Temp	94440-27001	m	89.87
50 Speedometer	94210-27000	m	181.50
51 Tachometer	94620-27000	m	139.55
52 Case, Cluster	94365-27000	m	24.39
53 Board, Printed Circuit	94367-27011	m	30.12
W/R&R Complete			

CENTER CONSOLE

Use Procedure Explanation 14 with the following text.

R&I Front Console

A



060-00818

1 Console, Front			
Base Model			
FX Model			
1997			
To 4-7-97	84611-27000-LK	7	69.85
From 4-7-97	84611-27100-LK	7	77.54
1998-99	84611-27000-LK	2	69.47
2 Armrest, Console	84612-27000-LK		2.99
3 Cover, Console Tray	84612-27000-LK		2.99
4 Cover, Park Brake Lever			
Base Model			
FX Model			
1997			
To 4-7-97	84690-27000-LK	22	22.50
From 4-7-97	84690-27100-LK	23	23.14
5 Cover, Console Upper			
Man Trans			
1997			
To 4-7-97	84651-27000	14	14.76
From 4-7-97	84651-27000-KW	14	14.76
1998-99	84651-27000-KW	14	14.76
Auto Trans			
1997			
To 4-7-97	84651-27100	14	14.76
From 4-7-97	84651-27100-KW	14	14.76
1998-99	84651-27100-KW	14	14.76
6 Clip, Spring (3)	85630-25000		91
7 Bolt, Hex Flat	84660-27000		28.96
8 Tray, Console			
1997			
To 4-7-97	83300-27500-LK	3	3.16
From 4-7-97	83300-27500-KW	3	3.16

1996-99	83300-27500-KW	3	3.16
9 Bracket, Console Mtg	84675-27000	8	15.12
#w/Console Removed			

ROCKER/PILLARS/FLOOR

Use Procedure Explanations 14, 15 and 28 with the following text.

SHEET METAL

Refinish Outer Hinge Pillar	RL	2.0
Refinish Hinge Pillar Section	RL	1.0
Refinish Rocker Panel	RL	1.4
Section Hinge Pillar	RL	7.5



060-01136

1 Pillar, Outer Hinge	R 7104-27A11	1	13.5	433.10
	L 7103-27A11	1	13.5	433.10
2 Pillar, Inner Hinge	R 7120-27050	w/Sunroof	2.5	395.00
	L 7120-27050	w/Sunroof	2.5	395.00
	R 7120-27A10		2.5	395.00
	L 7120-27A10		2.5	425.18
3 Panel, Outer Rocker	R 7132-27A10	#w/Quarter Panel Removed Deduct 1.6	#7.5	289.68
	L 7131-27A10	#w/Quarter Panel Removed Deduct 1.6	#7.5	289.68
4 Panel, Chr Lock Pillar	R 7140-27A10	#w/Quarter Panel Removed	#5.0	445.83
	L 7140-27A10	#w/Quarter Panel Removed	#5.0	445.83
5 Rail, Roof Side In	R 71381-27050		2.0	46.89
	L 71371-27050		2.0	46.89
	w/Sunroof		2.0	46.89
	L 71371-27000		2.0	46.89

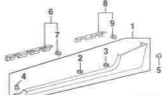

060-00821

1 Moulding Assy, Rocker Panel (P)	R 8775-27011	5	217.13
	L 87751-27011	5	217.13
(P) Panel to Match			
2 Clip, Moulding(P)	RL 87770-27000		1.50
Type 1 (75/95)	RL 87758-35000		1.03
Type 2 (55/85)	RL 87759-27000		1.53
3 Grommet, Midg (7/5Side)	Included w/Rocker Panel Moulding Assy		
4 Retainer, Midg (2/5Side)	R 8690-28000		1.35
5 Bracket Assy, Moulding Front Mounting	R 87755-27000		12.41
	L 87757-27000		12.41
6 Retainer, Fit Bracket (4/5Side)	R 87759-23000		1.48
7 Bracket Assy, Moulding Rear Mounting	Included w/Moulding Front Mounting Bracket Assy		
	R 87768-27000		11.74
	L 87761-27000		11.74
8 Retainer, Rear Bracket (3/5Side)	RL 87759-23000		1.48
Included w/Moulding Rear Mounting Bracket Assy			

INTERIOR TRIM



060-00822

1 Moulding Assy, Windshield Garnish-See Windshield Section	R 8684-27000-LK	3	17.35
2 Trim, Cowl Side	R 86823-27101-LK	3	24.89
3 Puller, Fuse	L 91817-33A00		81
4 Grommet (2/5Side)	L 14810-25000		17
5 Plate, Scuff	R 85861-27000-LK	2	20.56
	L 85871-27000-LK	2	20.56
6 Trim, Scuff Plate	R 85876-27000-LK	2	26.19
	L 85875-27000-LK	2	26.19
7 Clip, Trim Mtg (4/5Side)	RL 85870-27000		6.08

FRONT SEAT

R&I Front Seat Assy

RL 3

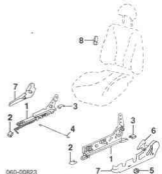

060-00823

EXTERIOR TRIM

Refinish Rocker Panel Moulding Assy	RL	1.5
R&I Rocker Panel Moulding Assy	RL	3.0

1 Adjuster, Seat Track			
Passenger Side			
	R	R 8523-27002	R#B 153.98
	L	R 8524-27002	R#B 112.82
1999			
To 10-1-98			
	R	R 8523-27002	R#B 153.98
	L	R 8524-27002	R#B 112.82
From 10-1-98			
	R	R 8523-27002	R#B 153.98
	L	R 8524-27002	R#B 112.82
Driver Side			
	R	R 8512-27002	R#B 102.75
	L	R 8511-27002	R#B 137.47
FX Model			
	R	R 8512-27101	R#B 102.75
	L	R 8511-27101	R#B 153.98
#R#R Both One Seat 9			
2 Cover, Frt Seat Mtg			
Outer			
	R/L	R 8551-26004-LK	1.03
Inner			
	R/L	R 8553-26004-LK	1.03
3 Cover, Rear Seat Mtg			
Outer			
	R/L	R 8555-26004-LK	.76
Inner			
	R/L	R 8557-27104-LK	1.08
	R/L	R 8559-27104-LK	1.08
4 Bar, Connector			
	R/L	R 8543-22001	2.50
5 Handle, Seat Height Adj			
	R/L	R 8504-27104-LK	2.25
	R/L	R 8520-27000-LK	3.15
6 Knob, Recliner			
	R/L	R 8510-27000-LK	3.15
	R/L	R 8525-27000-LK	3.15
7 Cover, Seat Adj			
	R/L	R 8518-27000-LK	14.69
	R/L	R 8519-27000-LK	34.89
8 Handle, Lumber Suppt Adj			
	R/L	R 8570-34000-LK	2.80

REAR SEAT			
R#R Rear Seat Assy			5

SEAT BELTS

FRONT



1 Belt, Retractor Side Seat			
	R	R 8690-27551-LK	#1.0 87.58
	L	R 8670-27551-LK	#1.0 87.58
Includes R#R Quarter Trim			
2 Belt, Buckle Side Seat			
	R	R 8640-27550-LK	3 24.86
	L	R 8630-27550-LK	3 37.81
3 Cover, Seat Belt Anchor			
	R/L	R 8612-26650-LK	1.17
	R/L	R 8611-26650-LK	1.17
4 Adjuster, Height			
	R/L	R 8690-27550-LK	52.78

REAR



1 Belt, Rear Seat Outer			
	R	R 8620-27550-LK	173.43
	L	R 8610-27550-LK	173.43
2 Belt, Center			
	R	R 8640-27550-LK	8.7 47.81
	L	R 8630-27550-LK	8.7 47.81
#R#R Complete, Includes R#R Rear Seat Assy			
3 Cover, Seat Belt Anchor			
	R/L	R 8612-27500-LK	2.89

FRONT DOOR

Use Procedure Explanations 16 and 29 with the following list.

SHEET METAL			
Refresh Door Outside		R/L	2.1
Add for Jamb & Interior		R/L	1.8
Add for Jamb		R/L	5

R#R Door Assy R/L 1.0

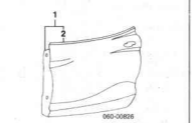

1 Shell Assy, Door			
	R	R 76004-27050	84.0 523.31
	L	R 76003-27011	84.0 509.31
	R	R 76111-27010	85.5 211.74
	L	R 76111-27010	85.5 211.74
2 Panel, Door Repair			
Includes w/Door Shell Assy			
Includes R#R Mirror			

EXTERIOR TRIM

Refresh Rear View Mirror	R/L	4	
R#R Belt Mtg	R/L	3	
R#R Rear View Mirror	R/L	3	

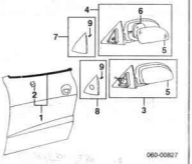

1 Molding Assy, Belt			
	R	R 82220-27000	3 134.89
	L	R 82110-27000	3 134.89
2 Clip, Belt Mtg (R/Side)			
	R/L	R 82219-27000	1.46
Mirror Assy, Rear View (P)			
3 Manual			
	R	R 87906-27600	3 152.86
	L	R 87905-27600	3 161.61
	R	R 87906-27700	3 236.33
	L	R 87905-27700	3 235.09
4 Power			
	(P) Paint to Match		
5 Mirror & Holder			
	R	R 87908-27200	35.27
	L	R 87907-27000	26.63
6 Actuator, Pwr Mirror			
	R	R 87960-28000	127.40
	L	R 87959-28000	137.08
Includes w/Rear View Mirror Assy			
Cover Assy, Door Corner			
7 Man-Mirror			
	R	R 87660-27000	13.26
	L	R 87659-27000	13.27
8 Pwr Mirror			
	R	R 87660-27010	13.27
	L	R 87659-27010	13.27
9 Fastener, Cover (2/Side)			
	R/L	R 86039-22000	.91
Includes w/Door Corner Cover Assy			

INTERIOR TRIM

R#R Trim Panel R/L 4			
NOTE: All Parts in this section are included in R#R Trim Panel unless noted otherwise.			
Illustration Located in Next Column			
1 Panel Assy, Trim			
Base Model			
	To 4-7-97	R 82302-27060-LK	5 455.39
	From 4-7-97	R 82301-27060-LK	5 455.37
	R	R 82303-27060-KJ	5 455.37
	L	R 82302-27060-KW	5 455.37
	R	R 82302-27060-KJ	5 455.37
	L	R 82301-27060-KW	5 455.37
1997			
	To 4-7-97	R 82303-27050-LK	5 467.91
	R	R 82301-27050-LK	5 467.91
	From 4-7-97	R 82302-27050-KJ	5 467.91
	L	R 82301-27050-KW	5 467.91
	R	R 82302-27050-LK	5 467.91
	L	R 82301-27050-KJ	5 467.91
1998-99			

REAR TRIM PANEL

NOTE: All Parts in this section are included in R#R Trim Panel unless noted otherwise.			
Illustration Located in Next Column			
1 Panel Assy, Trim			
Base Model			
	To 4-7-97	R 82302-27060-LK	5 455.39
	From 4-7-97	R 82301-27060-LK	5 455.37
	R	R 82303-27060-KJ	5 455.37
	L	R 82302-27060-KW	5 455.37
	R	R 82302-27060-KJ	5 455.37
	L	R 82301-27060-KW	5 455.37
1997			
	To 4-7-97	R 82303-27050-LK	5 467.91
	R	R 82301-27050-LK	5 467.91
	From 4-7-97	R 82302-27050-KJ	5 467.91
	L	R 82301-27050-KW	5 467.91
	R	R 82302-27050-LK	5 467.91
	L	R 82301-27050-KJ	5 467.91
1998-99			

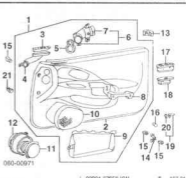

2 W/Srip, Inner			
	R	R 82301-27050-KW	5 467.91
	L	R 82314-27000	26.75
	R/L	R 82331-27000	28.79
3 Grille, Side DeFroster			
1997			
	To 4-7-97	R 82883-27000-LK	4.31
	L	R 82873-27000-LK	4.31
	From 4-7-97	R 82883-27000-KU	4.31
	L	R 82873-27000-KU	4.31
	R	R 82883-27000-LK	4.31
	L	R 82873-27000-LK	4.31
4 Nozzle, Side DeFroster			
	R/L	R 82890-27000	9.02
	R/L	R 82870-27000	9.52
5 Grommet, Air Vent			
	R/L	R 87495-27000	5.78
6 Duct Assy, Side Air Vent			
	R/L	R 87490-27000	16.88
	R/L	R 87480-27000	15.68
7 Nozzle, Side Air Vent (a)			
1997			
	To 4-7-97	R 87450-27000-CA	6.86
	L	R 87440-27000-CA	7.57
	From 4-7-97	R 87450-27000-KW	7.37
	L	R 87440-27000-KW	7.37
	R	R 87450-27000-KW	7.37
	L	R 87440-27000-KW	7.37
(a) Includes w/Side Air Vent Duct Assy			
8 Handle, Pull			
	R	R 82220-27000-CA	2 73.77
	L	R 82210-27000-CA	2 73.77
9 Pocket, Map			
1997			
	To 4-7-97	R 82380-27000-LK	2 57.98
	L	R 82370-27000-CA	2 57.98
	From 4-7-97	R 82380-27000-KU	2 57.98
	L	R 82370-27000-KU	2 57.98
	R	R 82380-27000-KU	2 57.98
	L	R 82370-27000-KU	2 57.98
	R	R 82371-27000-LK	6.41
	L	R 82710-27000-LK	9.41
Includes w/Trim Panel Assy			
11 Speaker, Stereo			
	w/4 Speaker System	R 86330-27200	8.2 39.77
	w/6 Speaker System	R 86330-27100	8.2 42.51
#R/Trim Panel Removed, Not Included in R#R Trim Panel			
12 Protector, Speaker			
	R/L	R 86331-27000	6.43
13 Grommet, Mtg (2/Side)			
	R/L	R 82317-27000	1.00
14 Bkt, Pull Handle (2/Side)			
	R/L	R 82715-27000	3.26
15 Cap, Pull Handle			
	R/L	R 14911-06000	.26
(R/Side, Full Trim Panel)			
Front			
	R	R 82723-27000-CA	1.46
	L	R 82713-27000-CA	1.46
	R	R 82724-27000-CA	1.46
	L	R 82714-27000-CA	1.46
17 Switch, Window Main			
Base Model			
	R/L	R 82670-27000	39.64
FX Model			
	R/L	R 82670-27100	51.56
(Order by Application)			
18 Switch, Window Sub			
	R	R 82680-27000	152.50
19 Switch Assy, Door			
	R/L	R 82660-25101	3.82
20 Cap, Door Switch			
Includes w/Door Switch Assy			
21 Fastener, Door Trim (2/Side)			
	R/L	R 82315-30020	.86

HARDWARE

Refresh Outside Handle	R/L	4
Refresh Upper Hinge	R/L	2
Refresh Lower Hinge	R/L	2
R#R Outside Handle	R/L	8.7

Includes R#R Trim Panel

Illustration Located in Next Column

1 Latch Assy			
	R	R 81320-27000	8.3 69.83
	L	R 81310-27000	8.3 69.83
#w/Trim Panel Removed			
2 Rod, Latch			
	R	R 81384-27000	2.14
	L	R 81383-27000	2.14
3 Clip, Rod			
	R/L	R 81327-27000	1.06
Includes w/Latch Assy			
4 Cover, Door Latch			
	R	R 81329-27000	1.66

1997	R 82860-27000	A	103.03
To 12-5-96	L 82850-27000	A	103.03
From 12-5-96	R 82860-27001	A	105.86
	L 82850-27001	A	105.86
1998-99	R 82860-27001	A	105.86
	L 82850-27001	A	105.86

INTERIOR TRIM W/O SUNROOF

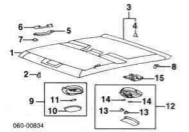

1	Headliner	86001-27000-LK	1.9	398.48
	FX Model	85301-27101-LK	1.9	370.28
2	Clip, Headliner (4)	85325-27000-LK	3	55
3	Trim Assy, Roof Rear Cover	86330-27000-LK	3	173.70
4	Clip, Trim (5)	85838-22000		.91
	Included w/Roof Rear Cover Trim Assy			
5	Grip, Assist	85340-33000-LK	2	173.70
6	Bracket, Assist Grip	85360-27000		10.69
7	Cover, Assist Grip	85343-28100-LK		2.01
8	Hook, Coat (2)	85355-27000-LK	1	2.45
9	Lamp Assy, Room			
	Base Model			
	1997			
	To 4-7-97	82900-22050-LK	3	14.32
	From 4-7-97	82900-22050-KU	3	14.32
10	Lamp (1)	82900-22050-KU	2	14.32
11	Ball (1)	92811-22050	2	1.91
12	Ball (1)	18645-10009	2	.94

12	Lamp Assy, Room			
	FX Model	82910-27510-LK	3	72.31
13	Lamp (1)	R 82920-27000	2	2.04
	L 82920-27000			2.04
14	Ball (1)	RL 19640-08019		.94
	Included w/Room Lamp Assy			
15	Bracket, Lamp	85829-27000		12.07

SUNROOF

RM Sunroof Assy	#2.0
OH Sunroof Assy (includes RM)	#3.0
#Headliner Removed	

NOTE: All Parts in this section are included in overhaul unless noted otherwise.

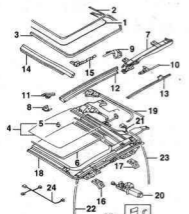

1	Glass, Sunroof	81610-27001	#2.4	441.78
2	WStrip, Sunroof	81613-27000	#2.4	38.54
	#RM Complete, #Headliner Removed			
3	Seal, Trim	81623-27000	6	6.20
4	Support Assy	81666-27000-LK	#2.4	158.40
	#Headliner Removed			

5	Clip, Trim (7)	81662-27000	1.06	
	Included w/Sunshade Assy			
6	Trim, Sunroof Opening	81661-27000-LK	#2.4	56.36
	#Headliner Removed, Includes RM/JS			
7	Lifter, Sunroof	R 81665-27000	183.70	
	L 81666-27000		15.05	
8	Holder, Sunroof Front	R 81668-27000	16.90	
	L 81667-27000		23.34	
9	Holder, Sunroof Rear	R 81668-27000	23.24	
	L 81679-27000		114.04	
10	Slider, Sunroof	R 81678-27000	114.04	
	L 81678-27000		5.32	
11	Rail, Drip	R 81694-27000	5.32	
	L 81693-27000		5.22	
12	Rail, Guide	R 81678-27000	60.01	
	L 81678-27000		19.88	
13	Guide, Sunroof	R 81639-27000	19.88	
	L 81639-27000		19.88	
14	Deflector, Air	R 81641-27000	4	162.41
	L 81643-27000		61.63	
15	Link, Deflector	R 81641-27000	61.63	
	L 81641-27000		5.37	
16	Rail, Sunroof Front	RL 81674-27000	3.42	
17	Rail, Sunroof Rear	RL 81671-27000	3.42	
18	Housing, Sunroof	81620-27000	#3.0	263.14
	#Headliner Removed			
19	Tube, Drive	81635-27000	150.56	
20	Motor, Sunroof	81631-27000	1.5	227.79
21	Relay			
	Type A	81640-27000		66.77
	Type B	81650-27000		48.08
22	Hose, Front Drain	RL 81681-27000	9.43	
23	Hose, Rear Drain	RL 81662-27000	6.21	
24	Wiring, Sunroof	81636-27000	54.37	
25	Wrench, Sunroof	81675-27000	6.88	

QUARTER PANEL

Use Procedure Explanations 28 and 29 with the following text.

SHEET METAL/EXTERIOR TRIM			
Refresh Quarter Panel Outside	RL	2.1	
Add to Play	RL	5	
Add to Edge Panel	RL	5	
Refresh Fuel Door	RL	4	
R&R Both Quarter Panels		24.3	
R&R Roof & Both Quarter Panels		38.3	
w/Sunroof		36.3	
R&R Rear Body Panel & Both Quarter Panels		25.7	
R&R Roof, Both Quarters & Rear Body Panel		39.7	
w/Sunroof		37.7	
Add to R&R Quarter Panel		37.7	
To R&R Quarter Glass	RL	2	

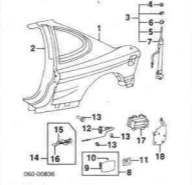

1	Panel, Outer Quarter	R 71502-27010	#13.0	360.08
	L 71501-27010		#13.0	360.08
	#Deduct 3.0 w/Roof Removed, Deduction Includes Common Surfaces & Included Operations			
2	Panel, Inner Quarter			
	1997	R 71902-27050	6	582.18
	L 71801-27050		6	582.18
	1998	R 71902-27050	6	582.18
	L 71801-27050		6	582.18
	From 8-20-97	R 71902-27051	6	598.20
	L 71801-27051		6	598.20
	1999	R 71902-27051	6	598.20
	L 71801-27051		6	598.20
3	Antenna Assy			
	1997	96230-27000	7	25.36
	To 11-27-97, Serviced by Components			
	1998-99 Serviced by Components			
	NAL Antennas	96227-34000	3	2.45
	Mod. Antennas	96233-34000	3	11.65
	Insulator, Antennas	96216-27000	6	61
	Base, Antennas	96258-27000	2	2.22
	Included w/Antenna Assy			
8	Door Assy, Fuel	L 69510-27000	3	38.86

9	Spring, Door	L 79533-27000	3.76	
10	Bumper, Door (2)	L 82851-22000	1.71	
	Included w/Fuel Door Assy			
11	Label, Fuel Filter-See Information Labels Section			
12	Catch & Cable	81666-27000	#	55.74
13	Clip, Cable (4)	86922-34000		.62
14	Handle Assy, Release			
	1997			
	To 5-6-97	81570-22010	3	18.71
	From 5-6-97	81570-22011	3	18.71
	1998-99	81570-22011	3	18.89
	Knob, Fuel Door Release	81275-22000	3	1.89
	Knob, Liftgate Release	81275-22000	3	5.22
	Included w/Release Handle Assy			
17	Grille, Air Extractor	L 27510-27000		10.09
18	Liner, Rear Wheel	R 86922-27000	2	12.47
	L 86921-27000		2	12.47

INTERIOR TRIM

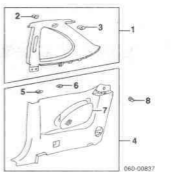

1	Trim Assy, Upper	R 85840-27100-LK	6.9	71.96
	Includes R&R Lower Trim Assy & R&R Rear Seat Assy			66.85
2	Clip, Trim Front (1)	RL 85838-22000		1.66
3	Clip, Trim Rear (2) (2) (2)	RL 85815-27000-LK		.51
	Included w/Upper Trim Assy			
4	Trim Assy, Lower			
	1997	R 85520-27000-LK	8.7	217.54
	L 85520-27000-LK		8.7	217.54
	1998	R 85520-27000-LK	8.7	217.54
	To 8-13-97	L 85520-27000-LK	8.7	217.54
	From 8-13-97	R 85520-27015-LK	8.7	230.33
	L 85510-27015-LK		8.7	230.33
	1999	R 85520-27015-LK	8.7	230.33
	L 85510-27015-LK		8.7	230.33
	Includes R&R Rear Seat Assy			
5	Clip, Trim Assy	RL 85515-34000		1.68
6	Clip, Spring (1) (1) (1)	RL 85838-22000		.91
7	Grille, Speaker (1)	R 85527-27000-LK		40.14
	L 85517-27000-LK			40.14
	Included w/Lower Trim Assy			
Speaker, Stereo				
w/4 Speaker System	RL 96360-27200			44.88
w/2 Speaker System	RL 96360-27100			72.05
w/CD Player	RL 96360-27000			49.86
w/CD Player	RL 96355-27000-LK			3.69

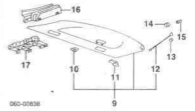

9	Trim Assy, Package Tray Center	85900-27100-LK	#1.0	298.12
	Includes R&R Rear Seat Assy			
10	Trim, Center Trim (1)	RL 85941-34000		2.58
11	Pin, Center Trim (1)	RL 85939-34000		2.23
12	Cable, Center Trim (1)	RL 85935-34000		6.10
	Included w/Package Tray Center Trim Assy			
13	Tube, Cable			
	1997	RL 85940-34000		5.39
	To 4-6-97	RL 85940-27000		5.39
	From 4-6-97	RL 85940-27000		5.39
	1998-99	RL 85940-27000		5.39
	14	Hanger, Ctr Trim	RL 85945-27000-LK	1.46
	15	Bracket	RL 14910-34000	.72
	16	Trim, Package Tray Side	RL 85950-27000-LK	2
	17	Bracket, Side Trim	RL 85950-27000-LK	2
	18	Bracket, Side Trim	RL 85950-27000-LK	2
	19	Bracket, Side Trim	RL 85950-27000-LK	18.86

QUARTER GLASS

R&I Quarter Glass R/L #1.8
 #Includes Clean Up Old Adhesive as Necessary

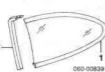

1 Glass, Quarter Hyundai	R R1829-27100 L 87819-27100	#1.8 137.68 #1.8 137.68
NAGS Green Trim	RL FQ20136-1G1N	#1.6 0.00
Green Trim	RL FQ20136-1G1Y	#1.6 0.00
#Includes Clean Up Old Adhesive as Necessary		
2 Garnish, Glass Front	R 82263-27000 L 82250-27000	34.00 34.00

LIFTGATE

Use Procedure Explanations 25 and 28 with the following text.

SHEET METAL/INTERIOR TRIM

Refresh Liftgate Outside	2.0
Add for Jamb & Interior	2
Refresh Hinge	R/L 2
R&I Gate Assy	7
R&I Lower Trim Panel	7
Add to R&I Liftgate	8
To Transfer Glass	8

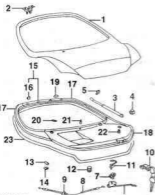

1 Shell, Liftgate w/Wiper	Z7200-27060	4.5 494.01
w/Spooler	Z7200-27070	4.2 446.74
w/Spooler	4.5 494.01	
w/Wiper	Z7200-27060	3.7 480.79
w/Spooler	R 79760-27040	#2 14.37
w/Spooler	R 79770-27000	#2 14.37
#w/Liftgate Removed		
3 Stay, Liftgate w/Spooler	RL 81770-27010	3 106.17
w/Spooler	RL 81770-27000	3 106.17
1997		
To 8-13-97	RL 81770-27020	3 106.17
From 8-13-97	RL 81770-27002	3 106.17
1999	RL 81770-27002	3 106.17
4 Cover, Stay Mtg	RL 81775-27005	8.5 1.37
5 Ball, Joint	RL 81163-30000	
6 Rod & Latch	81244-27000	#3 31.11
1998		
To 3-26-98	81240-27000	#3 31.11
From 3-26-98	81236-27010	#3 31.11
1999	81236-27010	#3 31.11
#w/Lower Trim Panel Removed		
7 Striker, Latch	81219-27010	2 14.71
1997		
To 10-27-97	81219-27000	2 14.71
From 10-27-97	81219-27016	2 15.94
1999	81219-27016	2 15.94
8 Cable, Latch Release	81280-27000	8 19.92
1997		
To 5-6-97	81280-27001	8 19.92
From 5-6-97		

1998-99	81286-27001	8 19.92
9 Clip, Cable	81194-30000	1.83
Cylinder & Key, Lock	82551-27001	#3 46.47
#w/Lower Trim Panel Removed		
11 Switch, Liftgate Lamp	97-89 86320-27000	4.29
12 Bumper, Lower	RL 81736-24210	2.75
13 Bumper, Side Upper	RL 81736-27000	2.67
14 Bumper, Side Lower	RL 81736-27002	10.46
15 Trim Assy, Upper	RL 81790-27000-LK	2 33.03
16 Clip, Trim(1) (4)	86839-20000	31
#Included w/Upper Trim Assy		
17 Trim, Side	R 81744-27000-LK L 81730-27000-LK	2 37.16 2 34.51
18 Trim, Lower	RL 81750-27000-LK	3 132.51
19 Plug, Push out Type	81746-27000	31
20 BMT, Lower Trim	R 81713-27000 L 81711-27000	2.40 2.40
21 Damper, Lower Trim (3)	86956-27000	3.80
22 Fastener, Lower Trim	RL 81757-29000	1.20
23 WStrip, Liftgate Opening	87321-27000	4 96.83

EXTERIOR TRIM

Refresh Air Spoiler	8	
1 Emblem	86300-27000	2 6.95
2 Spoiler, Air (P)	87211-27000	#8 305.00
(P) Paint to Match		
#Included in R&I Liftgate		
3 Pad, Spoiler Side Mtg	RL 87216-27000	2.85
4 Pad, Spoiler Cr Mtg	87215-27000	2.82
5 Lamp Assy, Stop-Side Rear Lamp Section		

GLASS & PARTS

1 Glass, Liftgate Hyundai	87110-27100 w/High Mount Stop Lamp 87111-27100 w/High Mount Stop Lamp F820138C7N NAGS (Green)	2.0 512.11 2.0 526.19 2.0 1136.75
2 Dam, Glass	81121-28000	28.44
3 Moulding, Panel	87131-27000	31.42

4 Blade Assy, Wiper	86360-37000	1 25.21
Insert, Blade(1)	86825-27000	1 5.01
5 Clip, Wiper	86369-24000	1 1.18
#Included w/Wiper Blade Assy		
7 Cam, Wiper	89110-27000	#2 25.80
#Includes R&I Insert or Blade Assy		
8 Arm, Wiper Arm	99815-27000	1.76
9 Nut, Flange	13395-06003	22
10 Motor & Linkage Assy	86700-27001	188.20
11 Bushing, Motor(2)	86711-24000	1.35
12 Bolt	86718-24000	1.75
#Included w/Motor & Linkage Assy		
13 Nozzle, Spray	86608-27001	2 7.00
14 Reservoir Assy, Washer-See Windshield Section		

REAR SUSPENSION

RL Suspension (One Side)	R/Lm 1.5
OH Suspension (Includes R/L)	

One Side	R/Lm 4.4
Both Sides	m 8.4
Adjust Four Wheel Alignment	m 1.0
ABS Brake System	
w/ABS	m 3
w/ABS	m 5

NOTE 1: R&I/R&R or OH Does Not Include alignment or bleed brake system.
 NOTE 2: All Parts in this section are included in overhaul unless noted otherwise.

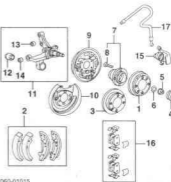

1 Drum, Brake	R&R Both Sides .5	RL 58411-29000	m #3 48.30
2 Shoe Set, Brake	58355-29000	m #1.4 41.54	
#Includes R&R Brake Drum			
3Rotor, Brake	R&R Both Sides 1.0	RL 58411-29010	m #6 69.23
4 Cap, Hub Grease	RL 52748-34000	2.31	
5 Nut, Bearing	RL 52745-37000	3.64	
6 Washer, Hub	RL 52744-37000	2.42	
7 Hub Assy			
w/ABS	RL 52710-29450	m #8 186.22	
1997			
To 11-5-97	RL 52710-29450	m #8 185.20	
From 11-5-97	RL 52710-29475	m #8 183.31	
1999	RL 52710-29470	m #8 186.75	
#Includes R&R Rotor, R&R Both Sides 1.4			
w/ABS	RL 52710-29400	m #8 158.00	
1997			
To 11-5-97	RL 52710-29400	m #8 158.00	
From 11-5-97	RL 52710-29495	m #8 143.20	
1999	RL 52710-29400	m #8 158.00	
#Includes R&R Drum, R&R Both Sides 1.4			
8 Bolt, Nut	RL 52712-22000	m 2.42	
9 Plate, Backing	R 86365-29000 L 86365-29000	m #2 54.86 m #2 54.86	
10 Shield, Splash	R 58244-29010 L 58243-29010	m #2 12.93 m #2 12.93	
#Hub Removed			
Sensor, ABS Rear-See ABS/Brakes Section			
11 Knuckle Assy, Steering	w/ABS	RL 52760-29100	m #2.3 252.05
w/ABS	RL 52760-29100	m #2.3 252.05	
w/ABS	R 52761-29000	m #2.3 244.15	
w/ABS	L 52762-29000	m #2.3 244.15	
#Includes R&R Hub, Drum or Rotor & Backing Plate or Splash Shield, R&R Both Sides 4.4			
12 Bushing, Trailing Arm(1)	RL 56116-29000	m 15.24	
13 Bushing, Susp Arm Frt(1)	RL 52815-29000	m 14.84	
14 Bushing, Susp Arm Rear	RL 52775-29000	m 13.05	
15 Caliper, Brake	R 58320-29420 L 58319-29420	m #5 184.92 m #5 184.92	
#w/Rotor Removed Deduct .3, R&R Both Sides .8			
16 Pad Set, Brake	58329-29A10	m #1.0 36.92	
#Each Caliper Removed Deduct .5			
17 Hose, Brake	R 82474-32010 L 82473-32010	m #3 36.92 m #3 36.92	
#w/Caliper or Backing Plate Removed Deduct .2			

Illustration Located in Next Column.

Order by Application		
19 Pad, Spring Lower	RL 55320-29000	m #1.3 3.94
20 Spring, Coil	RL 55329-27135	m #1.3 45.94
21 Cover, Dust	1967	
From 4-21-97	RL 55325-29100	m #1.3 5.47
From 4-21-97	RL 55325-27000	m #1.3 7.26
1969-99	RL 55325-27000	m #1.3 7.26

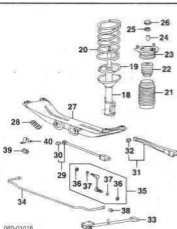

22 Bumper, Jounce Mount, Strut Upper	RL 55326-27000	m #1.3	13.95
23 Collar	RL 55313-20000	m #1.3	32
24 Nut, Flange	RL 54529-28000	m #1.3	43
25 R/R One Side Complete, w/Knuclde Removed Deduct .8	RL 95339-22000	m #	2.09
26 Cover, Strut Top Crossmember, Susp	RL 82610-28010	m #	363.87
27 Cap, Crossmember Dust	RL 55250-28001	m #1.2	1.23
28 Arm Assy, Front	RL 56210-27000	m #1.2	51.03
29 Bushing, Front Arm	RL 55215-28000	m	14.84
30 Arm Assy, Rear	RL 56220-29000	m #8	70.27
31 Bushing, Rear Arm	RL 52773-29000	m	13.05
32 Arm, Trailing w/ABS	RL 56101-29100	m #5	76.95
33 w/ABS	RL 56100-29100	m #5	76.95
34 w/ABS	RL 56101-28000	m #5	76.95
	RL 56100-29000	m #5	79.07
35 R/R Both Sides .8	55511-27000	m #7	53.00
36 Bar, Stabilizer	RL 55530-30000	m #5	25.26
37 Link Assy, Stabilizer	RL 54837-30000	Not included in OH	
38 Cover, Dust (2 Side)	RL 54838-30100	2.78	
39 Ring, Clutch (2 Side)	RL 55238-30100	1.29	
40 Nut, Flange (2 Side)	RL 13270-10001	m #2	6.10
41 Bushing, Stabilizer	RL 55513-27050	m #2	6.10
42 Bracket, Stabilizer	RL 55514-29010	m #2	3.11

FUEL TANK

NOTE: R/R/RAR Does Not include drain and refill

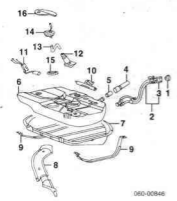

1 Cap, Fuel Filter	31010-28500	8.48
2 Pipe Assy, Filter		

1997	31040-27500	71.74
1998		
To 8-16-97	31043-27500	71.74
From 8-16-97	31043-27860	84.56
1999	31043-27860	84.56
3 Gasket, Filter Pipe	31045-24000	72
Included w/Filter Pipe Assy		
4 Hose, Fuel Filter	31036-29600	65.25
1998		
To 8-16-97	31036-29600	65.25
From 8-16-97	31036-29960	37.30
1999	31036-29960	37.30
5 Valve, Fuel Cut	31160-29950	3.90
1998		
To 8-16-97	31160-29950	3.90
From 8-16-97	31160-29966	4.01
1999	31160-29966	4.01
6 Tank, Fuel	31150-29600	241.53
1997		
1998	31150-29600	m 1.5 241.53
To 8-16-97	31150-29960	m 1.5 241.86
From 8-16-97	31150-29960	m 1.5 241.86
1999	31150-29960	m 1.5 241.86
Protector, Fuel Tank	31230-29600	43.35
Type 2	31235-29600	22.82
7 Type 2	R 31211-29600	15.70
8 Bead, Fuel Tank	L 31210-29600	15.70
10 Separator, Fuel	31050-29000	39.79
1997		
1998	31050-29000	39.79
To 8-16-97	31050-29000	39.79
From 8-16-97	31050-27980	39.79
1999	31050-27980	39.79
11 Sender, Fuel	94450-29610	m #7 53.46
12 Pump, Fuel	31111-22500	7.54
R/RAR Complete, Included in R/R Fuel Tank		
13 Hose, Fuel Pump	31116-30000	7.01
14 Plate, Fuel Pump	31112-30610	43.35
15 Insulator, Fuel Pump	31117-25500	4.01
16 Cover, Fuel Pump	31101-27000	3.80

REAR BODY

Use Procedure Explanations 26 and 28 with the following text.

SHEET METAL/EXTERIOR TRIM

Refinish Rear Body Panel	1.8
Add for Edge & Inside	.8
Refinish Rear Floor Pan	1.0

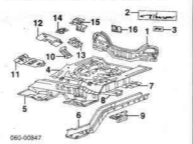

1 Body, Rear	80100-27010	#7.0 253.77
Deduct .2.8 for Each Quarter Panel Removed, Deduction Includes Common Surfaces & Included Operations		
2 Nameplate (Adhesive) "Tiburon"	86311-27000	2 36.93
3 Nameplate (Adhesive) "FX"	86313-27000	2 9.02
4 Pan, Rear Floor	65511-27010	#16.0 443.77
Ref/Rear Body Panel Removed, Deduct 2.5 for Each Inner Quarter Panel Removed		
5 Extension, Rear Floor	65790-27010	201.26
6 Rail, Rear Floor	RL 65720-27010	#7.0 352.84
RL 65710-27010	#7.0 352.84	
Ref/Rear Floor Pan Removed Deduct 3.0		
7 Reinft. Floor Cross	66521-27010	51.18
8 Crossmember, Floor	65751-27011	122.67
9 Panel, Rear Floor Side	R 66520-27011	27.81
L 66525-27011	27.81	
10 Support, Rear Floor	R 94198-27000	6.49
L 94196-27000	6.49	
11 Blvd., Rear Floor Up	R 66367-27000	57.95
L 66365-27000	57.94	
12 Reinft. Seat Belt Ctr Blvd. Jack Mtg	65318-27010	21.95
13 Blvd. Jack Mtg	65518-29000	12.84
14 Blvd. Spare Tire Mtg	65515-29000	8.96
15 Bead, Center Mtg	65536-27010	16.99
16 Plate, Side Mtg	RL 65655-27000	7.71

INTERIOR TRIM		
1 Trim Assy, Transverse	85770-27000-LK	2 31.81
Clp, Trim (B)	85639-20000	31
Included w/Transverse Trim Assy		
2 Trim, Rear Body	RL 85731-27000-LK	2 165.00
3 Plug, Rear Body Trim	RL 85629-29000-LK	2 2.78
4 Trim Assy, Luggage Side	RL 85740-27100-LK	3 102.54
5 Galle, Right Side Trim	RL 85734-27000-LK	6 8.56
6 Nut, Spring (10)	L 13633-00593	17
Included w/Luggage Side Trim Assy		
8 Grommet (4)	14010-05000	37
9 Mat, Luggage Compt	86710-27000-LK	258.78

REAR LAMPS

COMBINATION LAMP

R/L Combination Lamp Assy _____ R/L .4

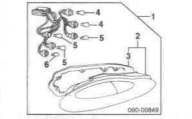

1 Lamp Assy, Combination	R 82402-27050	.4 126.92
2 Lens & Housing Assy	L 82401-27050	.4 126.92
R 82404-27050	.5 96.78	
L 82403-27050	.5 96.73	
3 Gasket, Lens (a)	RL 82406-27000	5 8.06
(a) Included w/Lens & Housing Assy		
4 Back-Up Signal	RL 18643-27007	6.2 1.34
5 Back-Up	RL 18642-27008	6.2 1.34
6 Bulb, Stop/Turn	RL 18644-29003	6.2 1.80
7 Bulb, Side Marker	RL 18643-29003-8	6.2 3.39
Included w/Combination Lamp Assy		
R/RAR All One Side		

LICENSE LAMP

R/L License Lamp _____ #2

Included in R/R or OH Bumper Assy

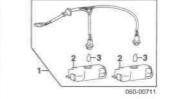

1 Lamp Assy, License	82501-27010	#2 27.08
Included in R/R or OH Bumper Assy		
2 Lens & Hse, Lamp	RL 82510-27003	6.2 4.46
R/RAR Complete, Included in R/R or OH Bumper Assy		
3 Bulb (7)	RL 18645-00009	34
Included w/License Lamp Assy		

HIGH MOUNT STOP LAMP ON LIFTGATE

Illustration Located in Next Column

1 Lamp Assy, Stop		
-------------------	--	--

REAR LAMPS Cont'd

HIGH MOUNT STOP LAMP ON LIFTGATE Cont'd

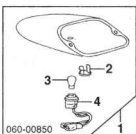

1997				
To 4-7-97	92750-27000-LK	#3	38.37	
From 4-7-97	92750-27000-KU	#3	38.37	
1998-99	92750-27000-KU	#3	38.37	
#Included in R&R Liftgate				
2 Cover, Mtg Hole				
1997				
To 4-7-97	R 92765-27000-LK		1.28	
	L 92764-27000-LK		1.28	
From 4-7-97	R 92765-27000-KU		1.28	
	L 92764-27000-KU		1.28	
1998-99	R 92765-27000-KU		1.28	
	L 92764-27000-KU		1.28	
3 Bulb, Stop Lamp				
4 Socket, Stop Lamp				
	18642-27008		.92	
	92759-27000		4.63	
#Included w/Stop Lamp Assy				

HIGH MOUNT STOP LAMP ON SPOILER

R&I Stop Lamp	#3
#Included in R&R Spoiler	

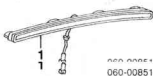

1 Lamp, Stop	92700-27000	#3	210.17
#Included in R&R Spoiler			

REAR BUMPER

Use Procedure Explanations 27 and 28 with the following text.

Refinish Rear Cover	22
R&I Bumper Assy	1.6
O/H Bumper Assy (Includes R&I)	24

NOTE: All Parts in this section are included in overhaul unless noted otherwise.

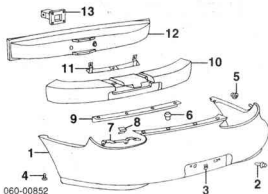

1 Cover, Rear (P)	86610-27010	24	224.46
<i>(P) Paint to Match</i>			
2 Bolt, License	R/L 11290-06161		.31
3 Nut, License	R/L 13341-06001		1.03
4 Screw, Cover	R/L 12441-05161		.17
5 Nut, Cover Side (2/Side)	R/L 13271-06001		.31
6 Retainer, Cover Mtg (6)	86590-28000		1.55
7 Bracket, Cover Side	R 86684-27000	IOH	13.65
	L 86683-27000	IOH	13.65
8 Clip, Bracket	R/L 86593-22000		.86
9 Bracket, Cover Center	86681-27000	IOH	16.25
10 Absorber, Impact	86620-27000	IOH	113.86
11 Bracket, Cover Lower	86685-27000	IOH	22.27
12 Bar, Reinf	86631-27010	IOH	255.29
13 Stay, Bumper	R 86642-27000	#2	59.44
	L 86641-27000	#2	59.44

#w/Bumper Assy Removed, Not Included in OH